



elnagh



EN

2020



elnagh

INDEX

OUR STORY	P.4
ELNAGH RANGE 2020	P.6
BODY PROTECTION SYSTEM	P.8
HEATING	P.10
WINTER SOLUTIONS	P.11
COMFORT AND FUNCTIONALITY	P.12
SAFETY AND MECHANICAL PARTS	P.14
BARON	P.16
T-LOFT	P.36
MAGNUM	P.54



BARON

P.16



BARON

P.16



T-LOFT

P.36



MAGNUM

P.54

OUR STORY

SINCE 1950 ON THE ROADS OF THE WORLD



IN 1954 THE "RICKSHAW" WAS BORN, the first product with wheels and the first of a long series of vehicles that will result in the current motorhomes and caravans



TODAY'S ELNAGH WAS BORN IN 1946. "Superflex" elastic forks, patented by Ghezzi, are made for bicycles equipped with an auxiliary motor



1980 MAGNUM, the first Elnagh motorhome



2010 the return of the Magnum



2015 For the 65th anniversary Elnagh presents the T-Loft Anniversary



2018 Elnagh presents the new Magnum series



IN 1950 THE COMPANY CHANGED ITS NAME: it took the name "Elnagh Elettromeccanica Ghezzi"

IN 1963 the construction of the motorhomes began and in 1965 all other activities were sold



1990'S TECHNOLOGICAL DEVELOPMENT View of one of the automatic feed assembly lines



The evolution of the motorhome in the mid-1990s



FOR 70 YEARS, ELNAGH HAS BEEN CREATING, INNOVATING AND REDESIGNING THE CONCEPT OF MOVEMENT. From the flexible fork for motor driven bicycles to the motorhome, Elnagh expresses all its exquisitely Milanese ingenuity with the same creativity that characterizes fabrics from the Eden of fashion. Elaborate words are no longer needed to describe it because each of its products contains everything that has always distinguished the brand and its history: inventiveness, determination and engineering. Thanks to its youthful inventors, skilled artisans, project technicians and designers, Elnagh is a company one step ahead of the game, offering elegant and functional solutions with an attention to detail that only solid experience can offer.

ELNAGH 2020 RANGE

WE ARE READY TO GO

Elnagh creates campers. An Elnagh camper is a jewel of precision and comfort.



BARON



BARON 22 ← l. 6990 mm →



BARON 26 ← l. 6990 mm →



BARON 65 ← l. 6990 mm →



T-LOFT



T-LOFT 450 ← l. 6990 mm →



T-LOFT 529 ← l. 6990 mm →



T-LOFT 530 ← l. 7410 mm →

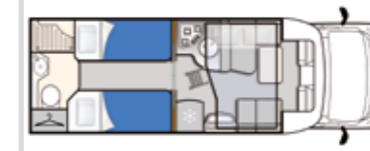

T-LOFT 531 ← l. 7410 mm →



T-LOFT 581 ← l. 7410 mm →



BARON



BARON 560 ← l. 6990 mm →



BARON 565 ← l. 6990 mm →



BARON 573 ← l. 7410 mm →

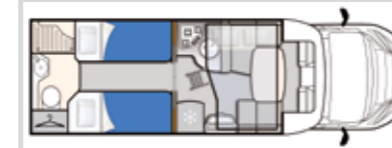

BARON 575 ← l. 7410 mm →



BARON 579 ← l. 7410 mm →



MAGNUM



MAGNUM 450 ← l. 6990 mm →



MAGNUM 529 ← l. 6990 mm →



MAGNUM 530 ← l. 7410 mm →



MAGNUM 531 ← l. 7410 mm →



MAGNUM 581 ← l. 7410 mm →

BODY PROTECTION SYSTEM

THE BODY STRUCTURE

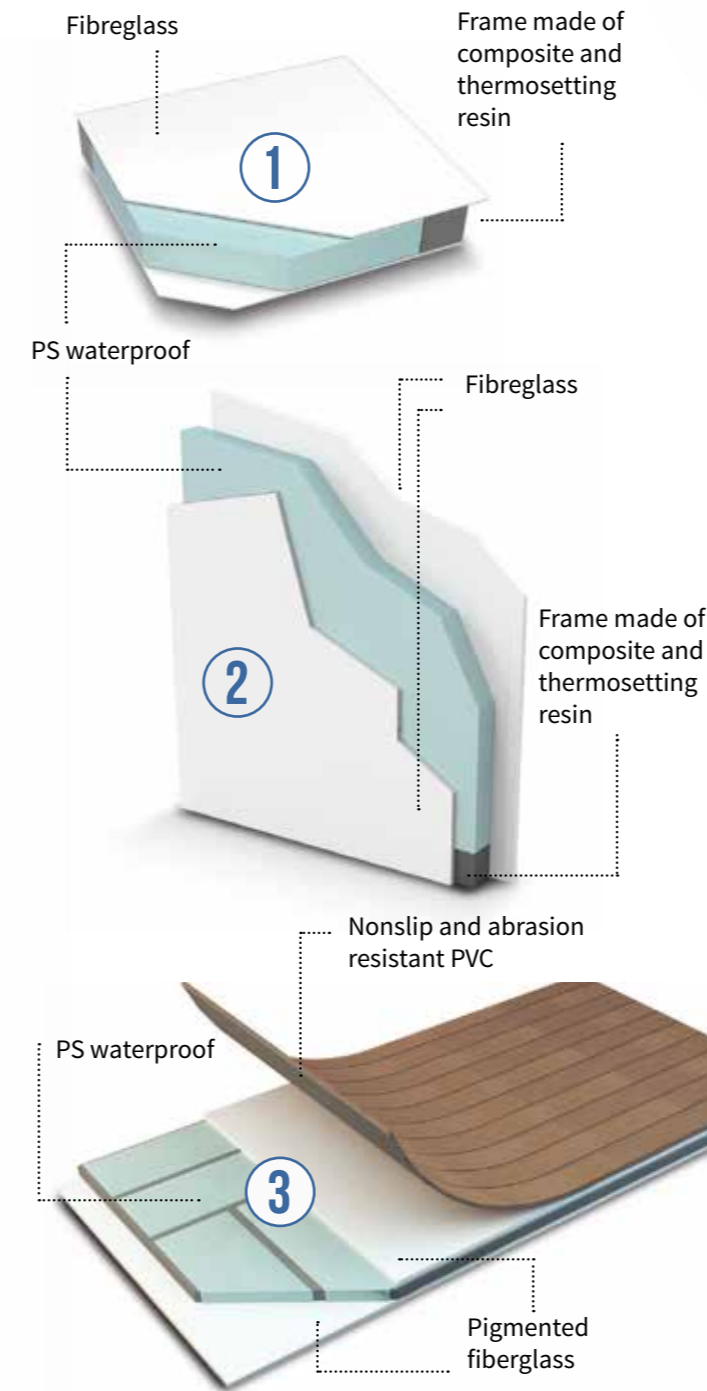

Body Protection System



1
Total absence of wood

2
Total waterproofing and higher heat insulation

5
Lighter and more resistant structure thanks to the use of bi-composite thermosetting resins

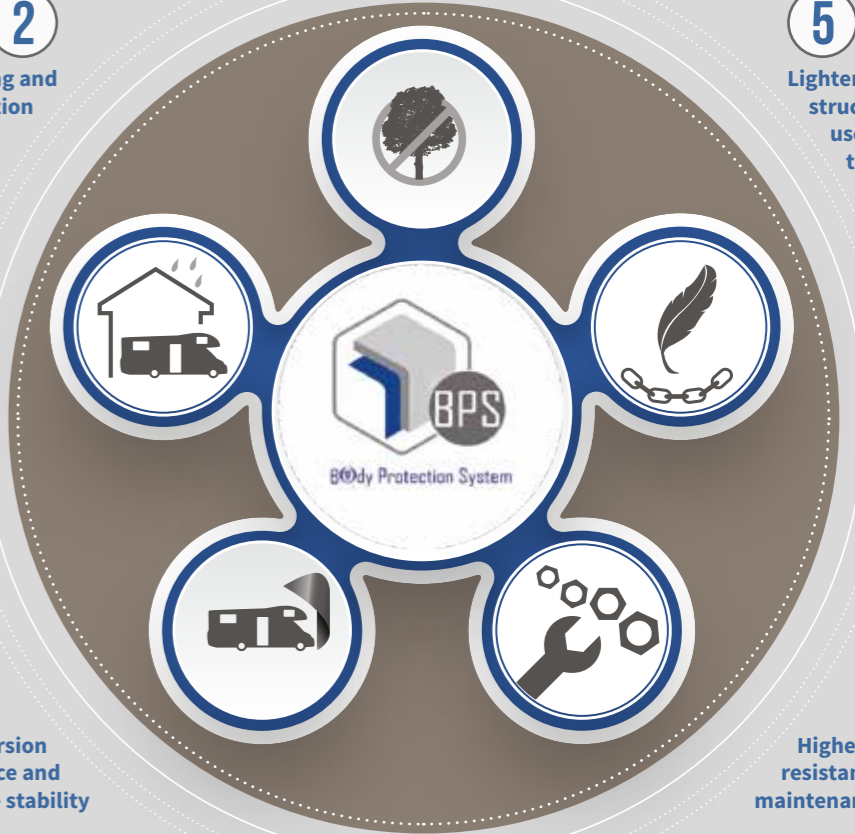

3
Highest torsion resistance and more stability

4
Higher wear resistance and easy maintenance

CHOOSE YOUR HEATING

WINTER TRAVEL DOESN'T BOTHER ME

AIR HEATING

Baron/ T-Loft / Magnum

Truma Combi is Europe's most compact heating, fuelled by gas (Baron) or diesel (T-Loft/ Magnum) with the option of additional electric heating (OPT.) FrostControl comes as standard, the current-free drain/safety valve for frost control.



DASHBOARD PROTECTION

Greater protection against cold draughts inside the passenger compartment. (OPT)



ISOLATED WASTE WATER

tank and exhaust valve with anti-freezing resistor (OPT)



WINDSHIELD EXTERNAL BLIND

Greater windshield protection against cold/heat (OPT)



INSULATED STEP

Greater floor insulation, more efficient protection against the cold (OPT)



HEATED WINDSHILD

Windshield with double function: defroster in winter season and solar heat protection during the summer. (OPT)



WINTER SOLUTIONS

DON'T LET THE COLD STOP YOU



UNDERFLOOR HEATING SYSTEM

In combination with the heating, it offers greater interior comfort thanks to the use of heating films (OPT where available)

COMFORT AND FUNCTIONALITY

ALWAYS COMFORTABLE, ESPECIALLY ON HOLIDAY

Elnagh has always given importance to colours and internal styles to live your motorhome in the name of relaxation and functionality. The trend is to recreate a comfortable and functional environment, making the most of the space available.



GARAGE DOORS IN FIBERGLASS. OPENING AND ACCESS TO THE GARAGE ON BOTH SIDES OF THE MOTORHOME.



VARIABLE VOLUME GARAGE. THANKS TO THE MANUAL MECHANISM, THE BED CAN BE CONVENIENTLY HEIGHT-ADJUSTED



VARIABLE VOLUME GARAGE PROVIDED ON THE TYPES:

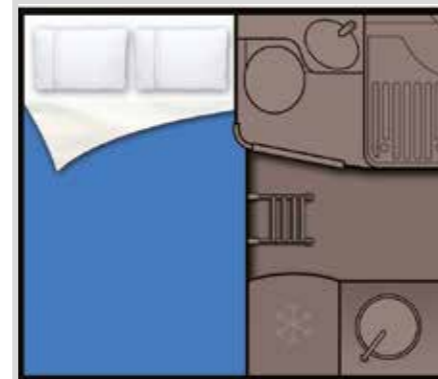

FULL-WIDTH BED
Baron 26 – Baron 560
T-Loft 450 – Magnum 450

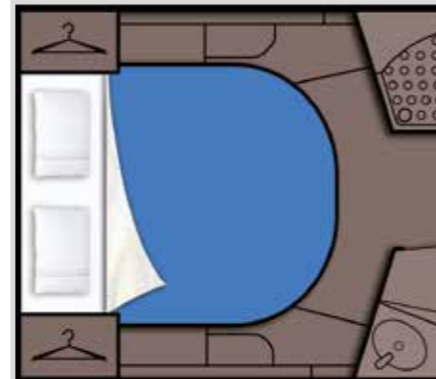

QUEEN BEDS
Baron 579 – T-Loft 581
Magnum 581

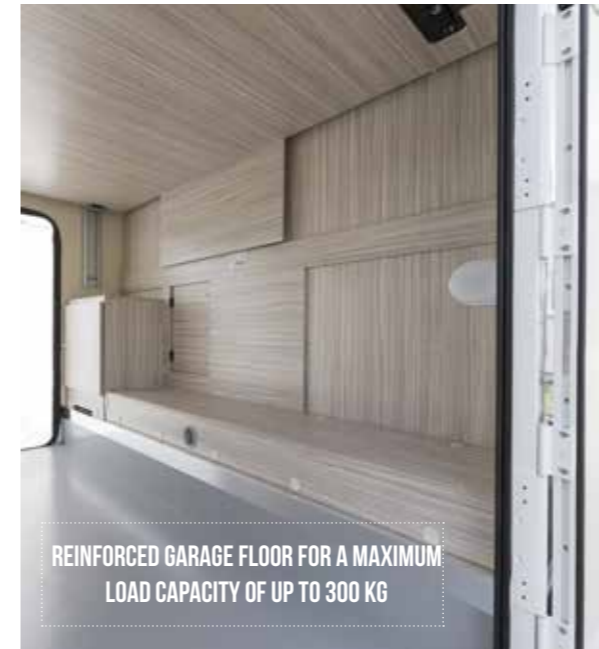

REINFORCED GARAGE FLOOR FOR A MAXIMUM LOAD CAPACITY OF UP TO 300 KG

STOWAGE IN THE LIVING AREA



WALL UNITS WITH LARGE DIMENSIONS, DESIGNED IN A RATIONAL AND FUNCTIONAL WAY THANKS TO THE DOUBLE SHELF



PRACTICAL FLOOR RECESSED STOWAGE HATCHES (T-LOFT AND MAGNUM RANGE)

STOWAGE IN THE SLEEPING AREA



CENTRAL BEDS WITH OPENING MECHANISM TO STORE EVEN THE MOST BULKY THINGS



LIFTABLE TWIN BEDS FOR WARDROBES, CLOSETS AND COAT RACKS

SAFETY AND MECHANICAL PARTS

FIAT

Created from the continuous cooperation with manufactures, Fiat Ducato is the perfect combination of chassis and living unit. There are many presettings to facilitate the transformation, a specific electrical system and a cab designed with reinforced uprights and pre-cut roof.

Extended rear track: 1980 mm. A width compared to the standard commercial vehicle track width greater of 19 cm.
More width means more space for internal living and greater stability.



STANDARD EQUIPMENT:



MANUAL CAB CLIMATE CONTROL: enhanced and diffused ventilation to the entire cab.



CRUISE CONTROL: for complete relaxation at the wheel, the speed is constant and the foot is free to move. Includes Speed limiter, which prevents you from exceeding the set maximum speed.



ESC: ESC: Electronic Stability Control, monitors acceleration, speed and grip. Includes roll-over mitigation, which improves stability by reducing roll, LAC (Load Adaptive Control) supervises the load distribution, ARS which prevents the drive wheels from slipping during acceleration.



MSR: MSR: (Motor Schleppmoment Regelung) prevents loss of grip in rough manoeuvres, HBA (Hydraulic Brake Assistance) helps the emergency braking, Hill Holder that keeps the vehicle stationary in the departures uphill.



TRACTION +: is the device to control the stability of the vehicle in conditions of poor grip of a single driving wheel. Includes Hill Descent Control for controlled speed on steep descents while saving brakes.



AUTOMATIC TRANSMISSION: 9-speed, for a relaxed and pleasant driving experience. Better performance: up to 12.5% more torque.

YOU CAN CHOOSE AMONG SOME OPTIONS:

SAFETY AND MECHANICAL PARTS

CITROËN

The style of the Citroën Jumper models is modern and takes up the latest codes of the brand: the signature of the chevrons combined with the daytime running lights, fluid lines not aggressive, but that transmit safety and robustness.

Inside Citroën vehicles, the interiors are welcoming and can be configured with swivel seats to facilitate movement on board. There are numerous practical and easily accessible compartments and the structure of the controls allows the driver to have everything within reach and sight (gear lever in the high position, central touch pad, ...).

The engine of the Citroën Jumper is equipped with the latest SCR-Ad-blue technology and complies with Euro 6.2 anti-pollution standards, thus reducing fuel consumption and CO2 emissions



STANDARD EQUIPMENT:

- **MANUAL CAB CLIMATE CONTROL**
- **ESC**
- **CRUISE CONTROL**
- **DOUBLE AIRBAG**
- **ELECTRIC HEATED DOOR MIRRORS**
- **HEIGHT-ADJUSTABLE SEATS WITH DOUBLE ARMREST**
- **DASHBOARD USB SOCKET + CUP HOLDER**
- **RADIO SETUP + CAB SPEAKERS**
- **LEATHER COVERED STEERING WHEEL AND GEAR LEVER KNOB**
- **TPMS: TYRE PRESSURE MONITORING SYSTEM**
- **ECO PACK: COMPOSED OF:**
 - **START AND STOP SYSTEM: FOR LOWER FUEL CONSUMPTION. AUTOMATICALLY RESTARTS WHEN THE ACCELERATOR PEDAL IS TOUCHED**
 - **SMART ALTERNATOR: INTELLIGENT ALTERNATOR THAT SUPPLIES ONLY THE NECESSARY ENERGY AND HIGH FUEL EFFICIENCY.**
 - **ELECTRONIC FUEL PUMP: FOR ENERGY SAVING**
- **AUTOMATIC LIGHTS**
- **RAIN SENSORS**
- **CITROËN CHROME FRONT GRILLE**





BARON

ELNAGH WELCOMES YOU INTO THE FAMILY



BARON 560



BARON 565

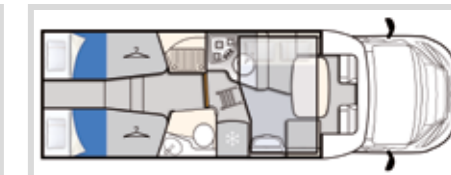

BARON 573

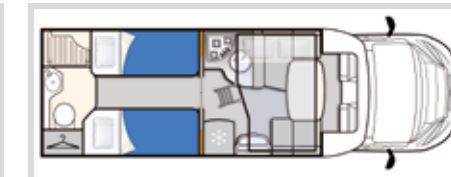

BARON 575



BARON 579

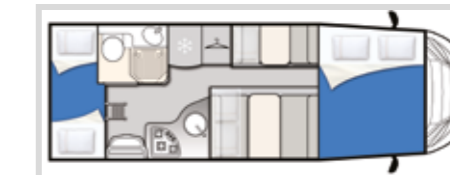

BARON 22

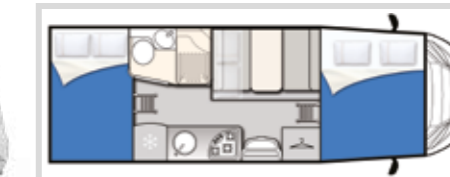

BARON 26

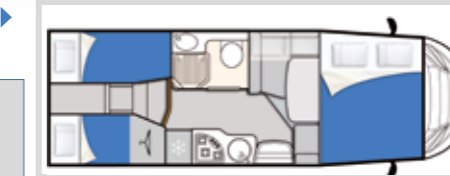

BARON 65



6990/7410 MM

 5-7	 4-7	 3500 KG 2,3 MJT 140 CV	 3500 KG 2,2 L BLUEHDI 140 CV	 COMBI 4	 142/150 LT.
--	--	---	---	--	--

Photographs may show vehicles fitted with optional features and may content photography props not included in the standard specification of the vehicle.



Seitz windows

Opening skydome with blinder and flyscreen

Pleated sliding mosquito net on entrance door

Living space door with window, bin and blind

IF YOU HAVE NEVER CLIMBED INTO AN ELMAGH CAMPER, BARON IS THE ONE FOR YOU.

Baron is the perfect camper for those who want to grab their bags and set off without any limitations. Baron is warm if you want to travel northwards and cool if you prefer to head south. It is comfortable in the winter and a pleasant refuge from the heat in the summer. Elmagh has already thought of everything, you just have to turn the key.



Upholstery under folding bed with LED backlit panel

Curved doors allow for more storage inside the wall unit

Entrance wall with mirror and practical storage pockets

Large refrigerator 142 l / 150 l depending on model

BARON 579

THE UPHOLSTERY OF THE BARON RANGE OF LOW-PROFILES AND COACHBUILDS



MILK (STD)



SUGAR (OPT)



COFFEE (OPT)

TYPES OF DINETTE ON THE BARON RANGE OF LOW-PROFILES COACHBUILDS

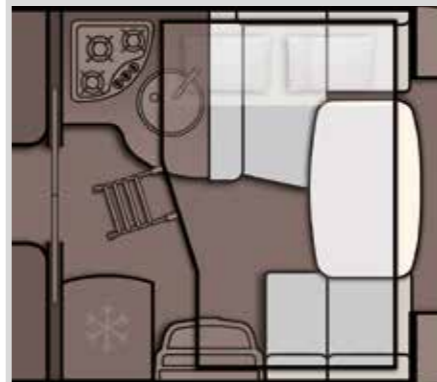

L-SHAPED DINETTE WITH BENCH OR DOUBLE SIDE BENCH

Baron 565 – Baron 560
Baron 579 – Baron 575
Baron 65

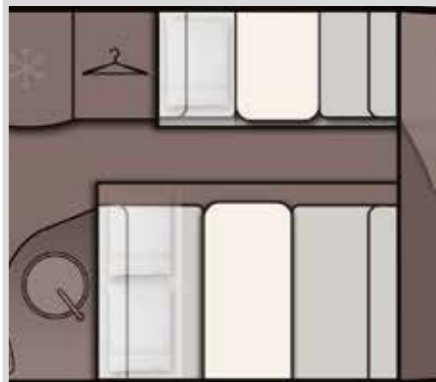

DOUBLE DINETTE

Baron 22

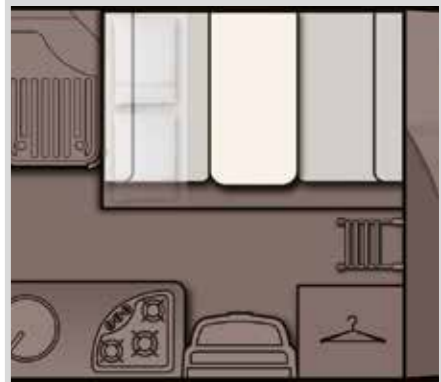

CLASSIC OPPOSING DINETTE

Baron 26

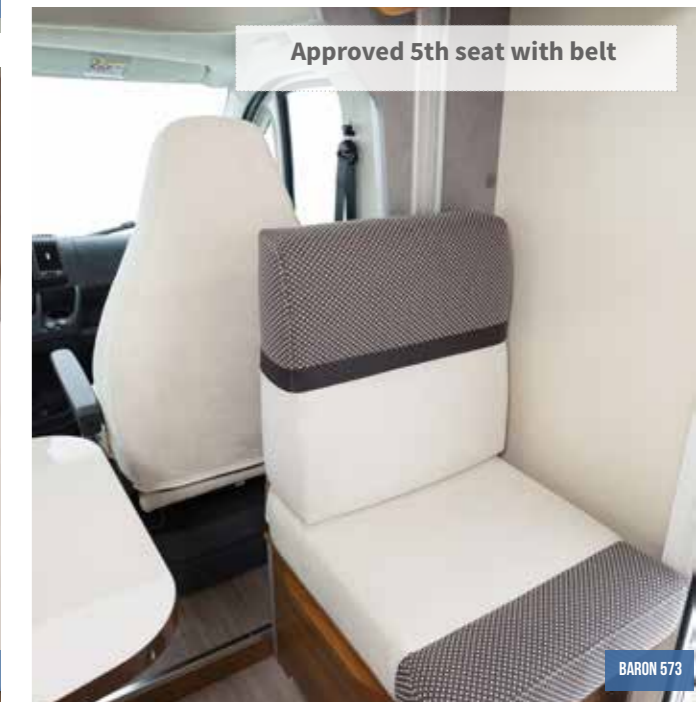





Kitchen peninsula with shelf and sliding basket

BARON 560

Large refrigerator 142 l / 150 l (depending on model)



Rooflight in the kitchen 40x40 cm

Kitchen window protection panel

Sliding lounge baskets (Baron 560)

BARON 560



BARON

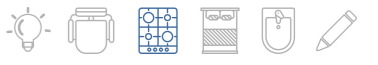

Practical wall units with two shelves

Extractor hood

Kitchen peninsula with shelf and sliding basket

Spacious, easily accessible drawers with practical opening handle

BARON 573

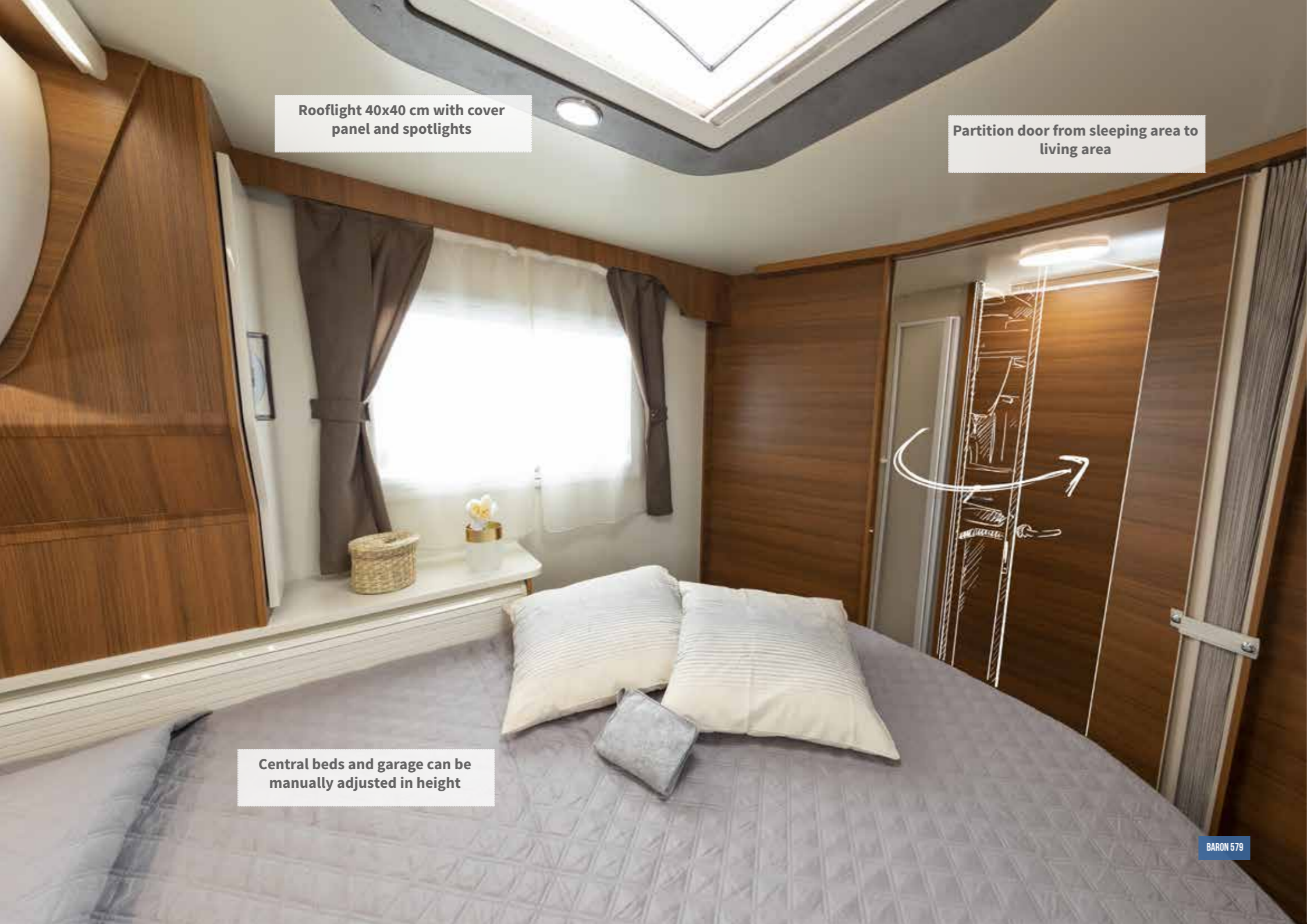

Rooflight 40x40 cm with cover panel and spotlights

Partition door from sleeping area to living area

Central beds and garage can be manually adjusted in height

BARON 579



BARON 579

- LARGE AND FUNCTIONAL STORAGE COMPARTMENT UNDER THE DOUBLE BED
- EVERYTHING IS IN ORDER IN THE COMPARTMENTS INSIDE THE STEPS
- CABINETS EQUIPPED WITH POLE TO HANG YOUR CLOTHES



BARON 579



BARON 560



BARON 560



BARON 560





Rigid door for your privacy

Shower separate from washbasin with rigid closing doors

Bathroom window with blinds

BARON 573

TYPES OF BATHROOMS ON THE BARON RANGE OF LOW-PROFILES AND COACHBUILDS



BARON 560

- SPACIOUS AND BRIGHT ROOM WITH A WINDOW AND BLIND.
- LARGE AND COMFORTABLE SHOWER SEPARATED FROM THE WASHBASIN.
- WALL UNIT, UNDER-WASH CABINET AND STORAGE COMPARTMENT ALLOW YOU TO HAVE EVERYTHING IN ORDER AND WITHIN EASY REACH.

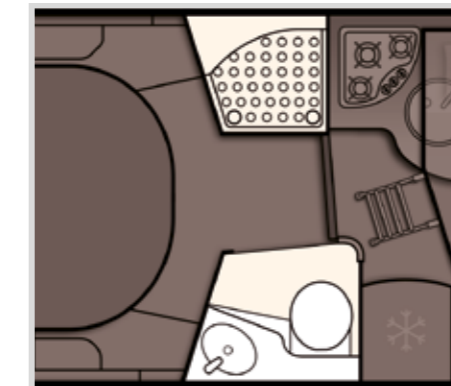

INDEPENDENT BATHROOM AND SHOWER
Baron 579 – Baron 573

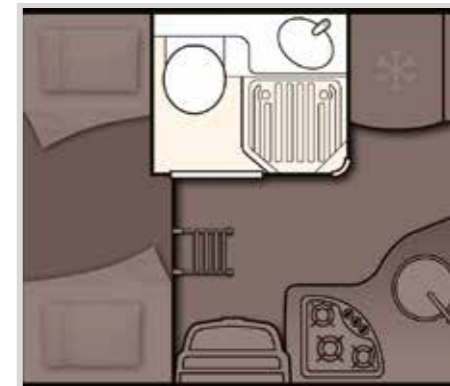

BATHROOM WITH SEPARATE SHOWER
Baron 560 – Baron 565 – Baron 22
Baron 26 – Baron 65

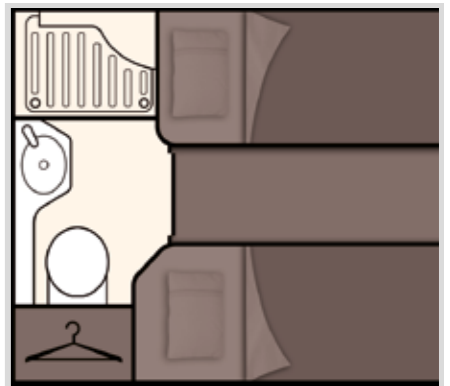

BATHROOM AND SHOWER AT THE END OF THE VEHICLE
Baron 575



BARON 573



BARON 579

MODEL	BARON 22	BARON 26	BARON 65	BARON 560	BARON 565	BARON 573	BARON 575	BARON 579
Wheels dimensions	15" (S)	15" (S)	15" (S)	15" (S)	15" (S)	15" (S)	15" (S)	15" (S)
Manual air conditioning	S	S	S	S	S	S	S	S
Driver and Passenger airbag	S	S	S	S	S	S	S	S
Cruise Control with speed limiter	S	S	S	S	S	S	S	S
ABS / ESC / Traction+	S / S / O	S / S / O	S / S / O	S / S / O	S / S / O	S / S / O	S / S / O	S / S / O
Swivelling driver' and passenger's seat	-	-	S	S	S	S	S	S
Cab seat covers	S	S	S	S	S	S	S	S
Frontbumper in white Fiat / Citroen	S / O	S / O	S / O	S / O	S / O	S / O	S / O	S / O
Dimensions and places								
Bed in Dinette	S	S	S	O	O	O	O	O
Rear Bed (mm)	890X2200X2	1400 X1260x2200	830x2000 + 830x1900 -1820x2120	1400 X2200	830x2000 + 830x1900 -1820x2120	830x2000X2 -1820x2120	750X1900-750X2050 -1400x2120	1600X1900
Bed in Dinette (mm)	1800X1250	1800X1250	2160x960x510	2160x1100x990	2160x960x510	2160x1070x570	2160x1140x870	2160x1070x570
Overcab bed (mm)	1500X2090	1500X2090	1500X2090	-	-	-	-	-
Elevating Bed (mm)	-	-	-	1950X1300X1100	1950X1300X1100	1950X1300X1100	1950X1300X1100	1950X1300X1100
Additional seat rear bed	-	-	S	-	S	S	S	-
Locker (useful opening, mm)	1250X700X2	1150X950X2	1150X800X2	1150X950X2	1150X800X2	1150X950X2	950X750 DX - 850X450 SX	1150X950X2
Max. internal garage height (mm)	1350	1175	1190	1150	1190	1180	770	1170
Floor / walls / roof thickness (mm)	54/31/31	54/31/31	54/31/31	54/31/31	54/31/31	54/31/31	54/31/31	54/31/31
Floor / walls / roof material*	VTR/VTR/VTR	VTR/VTR/VTR	VTR/VTR/VTR	VTR/VTR/VTR	VTR/VTR/VTR	VTR/VTR/VTR	VTR/VTR/VTR	VTR/VTR/VTR
Fiberglass roof, hail-proof	S	S	S	S	S	S	S	S
Installations								
Burners / Gas oven / Suction hood	3 / O / S	3 / O / S	3 / O / S	3 / O / S	3 / O / S	3 / O / S	3 / O / S	3 / O / S
Automatic trivalent fridge (220V, 12V, gas) (L)	149 L	149 L	142 L	142 L	149 L	149 L	149 L	149 L
Space for 2 gas bottles (tot. Max 15 Kg)	2X15 KG	2X15 KG	2X15 KG	2X15 KG	2X15 KG	2X15 KG	2X15 KG	2X15 KG
Bathroom window (double opaque glass)	S	S	S	S	S	S	S	S
Shower tray with double drain	S	S	S	S	S	-	S	-
Integrated and isolated entry step	S/O	S/O	S/O	S/O	S/O	S/O	S/O	S/O
Heated garage locker	S	S	S	S	S	S	S	S
Skylight								
Panoramic roof - OPEN SKY (mm)	-	-	-	S	S	S	S	S
Rear skylight (mm)	400X400	400X400 (S) / 960X655 (O)	400X400 (S) / 700X500 (O)	400X400 (S) / 960X655 (O)	400X400 (S) / 960X655 (O)	400X400 (S) / 960X655 (O)	400X400 (S) / 960X655 (O)	400X400 (S) / 960X655 (O)
Central skylight (mm)	400X400	400X400	400X400	400X400	400X400	400X400	400X400	400X400
Dinette skylight (mm)	700X500	700X500	700X500	-	-	-	-	-
Skylight toilette/shower (mm)	-	-	-	-	-	-	-	-
Double-glazed windows with blind / mosquito net	S	S	S	S	S	S	S	S
Equipments								
Rear bed manually adjustable	-	S	-	S	-	-	-	S
Beds with staves	S	S	S	S	S	S	S	S
Swivelling LCD holder	S	S	S	S	S	S	S	S
Internal LED lightening	S	S	S	S	S	S	S	S
Exteriors								
Entrance door with fixed window	S	S	S	S	S	S	S	S
Flyscreen for entrance door	S	S	S	S	S	S	S	S
Entrance door with two central locking points	S	S	S	S	S	S	S	S
External LED light	S	S	S	S	S	S	S	S

* VTR = Fibreglass

S= Standard O= Optional - = Not Available

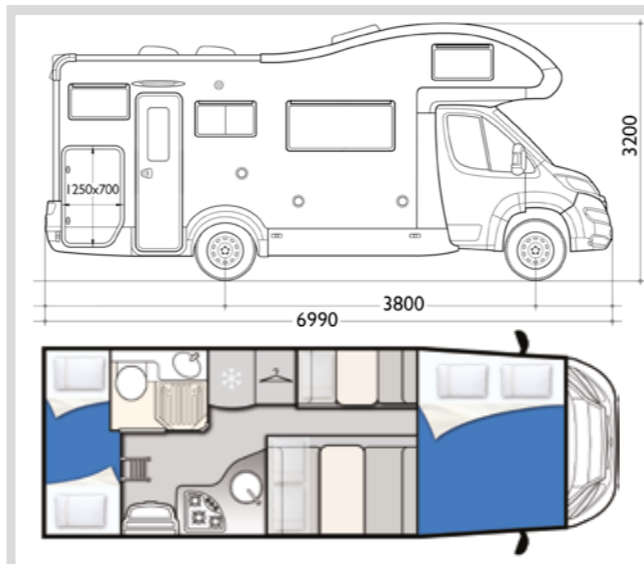

BARON 22

7	7	3500 KG 2,3 MJT 140 CV	3500 KG 2,2 L BLUEHDI 140 CV	COMBI 4

External length (mm) / External width (mm)	6990 / 2350
External height(mm) / Internal height (mm)	3200 / 2080
Wheelbase (mm)	3800
Maximum technically permissible weight (Kg)	3500
Weight in running conditions Min - Max (Kg)*	2835 - 2910
Max. user payload Min - Max (kg)*	590 - 665
Maximum towable weight (kg)	2000
Fresh water tank Lt. (total capacity when on the way)***	20 (118)/89
Standard heating system	COMBI 4 GAS

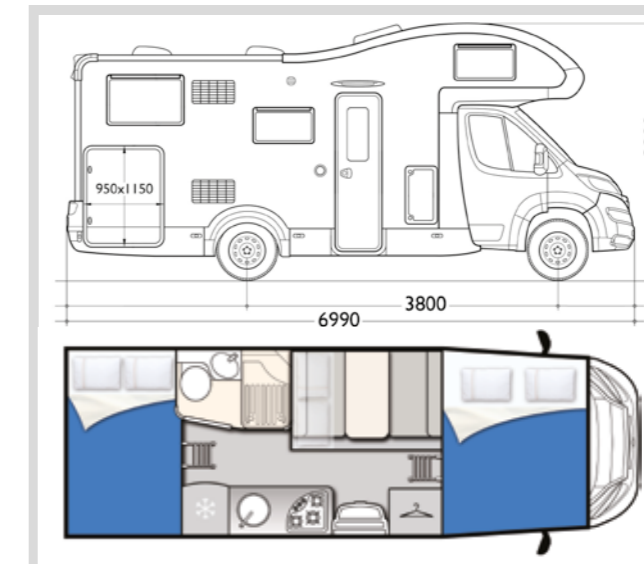

BARON 26

6	6	3500 KG 2,3 MJT 140 CV	3500 KG 2,2 L BLUEHDI 140 CV	COMBI 4

External length (mm) / External width (mm)	6990 / 2350
External height(mm) / Internal height (mm)	3200 / 2080
Wheelbase (mm)	3800
Maximum technically permissible weight (Kg)	3500
Weight in running conditions Min - Max (Kg)*	2910 - 2995
Max. user payload Min - Max (kg)*	505 - 590
Maximum towable weight (kg)	2000
Fresh water tank Lt. (total capacity when on the way)***	20(115)/100
Standard heating system	COMBI 4 GAS

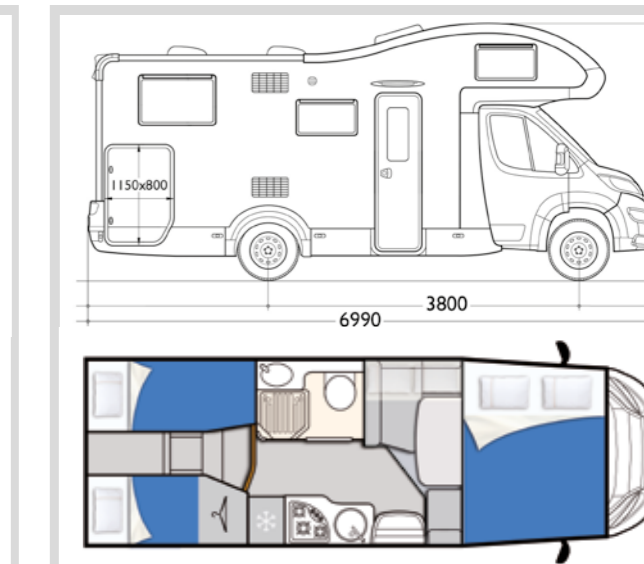

BARON 65

5	5	3500 KG 2,3 MJT 140 CV	3500 KG 2,2 L BLUEHDI 140 CV	COMBI 4

External length (mm) / External width (mm)	6990 / 2350
External height(mm) / Internal height (mm)	3200 / 2080
Wheelbase (mm)	3800
Maximum technically permissible weight (Kg)	3500
Weight in running conditions Min - Max (Kg)*	3010 - 3080
Max. user payload Min - Max (kg)*	420 - 490
Maximum towable weight (kg)	2000
Fresh water tank Lt. (total capacity when on the way)***	20 (118) /100
Standard heating system	COMBI 4 GAS

*The values shown represent the minimum value of the vehicle in the basic configuration, and the maximum value that includes the maximum weight of accessories available and that can be installed in the basic configuration in the factory.

The homologation data refer to the Fiat chassis. The Citroen chassis is in registration phase. - *** Pls. Check 20 lts. filling before driving

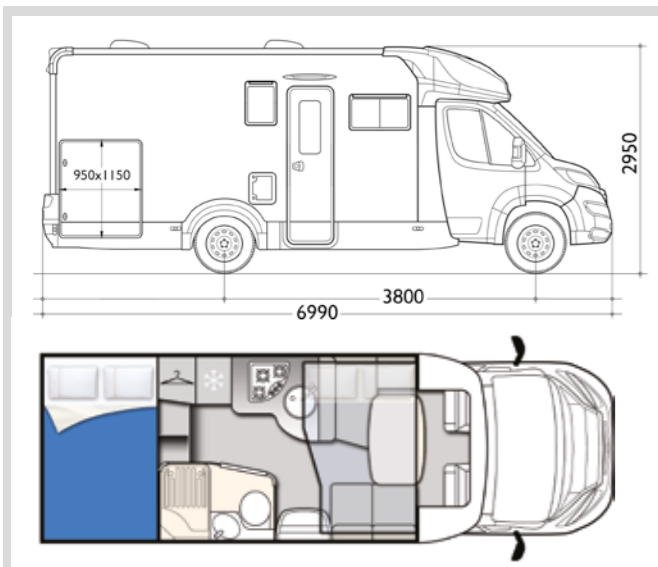

BARON 560

5	4	3500 KG 2,3 MJT 140 CV	3500 KG 2,2 L BLUEHDI 140 CV	COMBI 4

External length (mm) / External width (mm)	6990 / 2350
External height(mm) / Internal height (mm)	2950 / 2080
Wheelbase (mm)	3800
Maximum technically permissible weight (Kg)	3500
Weight in running conditions Min - Max (Kg)*	2960 - 3080
Max. user payload Min – Max (kg)*	420 - 540
Maximum towable weight (kg)	2000
Fresh water tank Lt. (total capacity when on the way)***	20 (118) /100
Standard heating system	COMBI 4 GAS

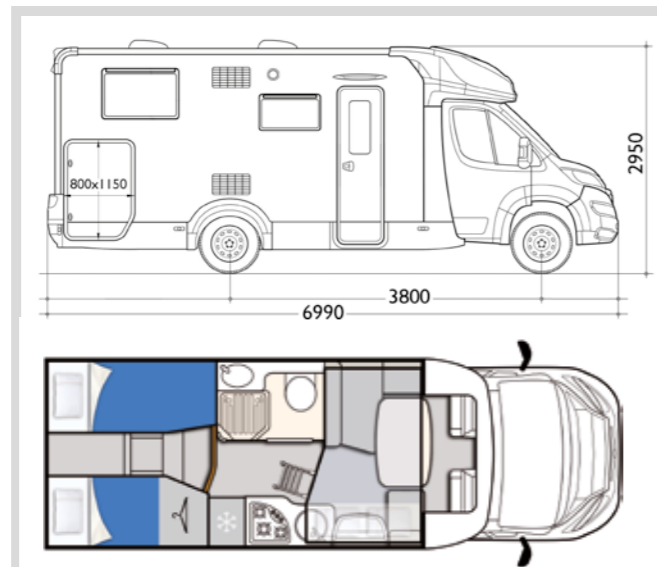

BARON 565

5	4**	3500 KG 2,3 MJT 140 CV	3500 KG 2,2 L BLUEHDI 140 CV	COMBI 4

External length (mm) / External width (mm)	6990 / 2350
External height(mm) / Internal height (mm)	2950 / 2080
Wheelbase (mm)	3800
Maximum technically permissible weight (Kg)	3500
Weight in running conditions Min - Max (Kg)*	2970 - 3080
Max. user payload Min – Max (kg)*	420 - 530
Maximum towable weight (kg)	2000
Fresh water tank Lt. (total capacity when on the way)***	20 (118) /100
Standard heating system	COMBI 4 GAS

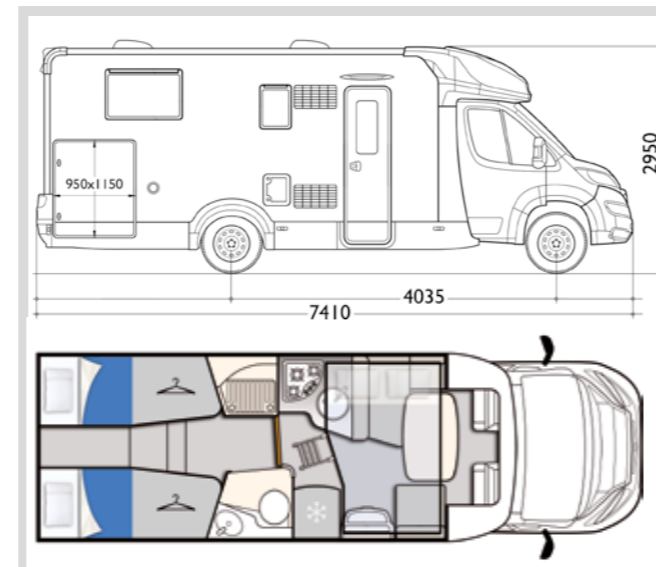

BARON 573

5	4**	3500 KG 2,3 MJT 140 CV	3500 KG 2,2 L BLUEHDI 140 CV	COMBI 4

External length (mm) / External width (mm)	7410 / 2350
External height(mm) / Internal height (mm)	2950 / 2080
Wheelbase (mm)	4035
Maximum technically permissible weight (Kg)	3500
Weight in running conditions Min - Max (Kg)*	2980 - 3075
Max. user payload Min – Max (kg)*	425 - 520
Maximum towable weight (kg)	2000
Fresh water tank Lt. (total capacity when on the way)***	20 (118) /135
Standard heating system	COMBI 4 GAS

Transformation of twin beds into a maxi double bed - * Pls. Check 20 lts. filling before driving

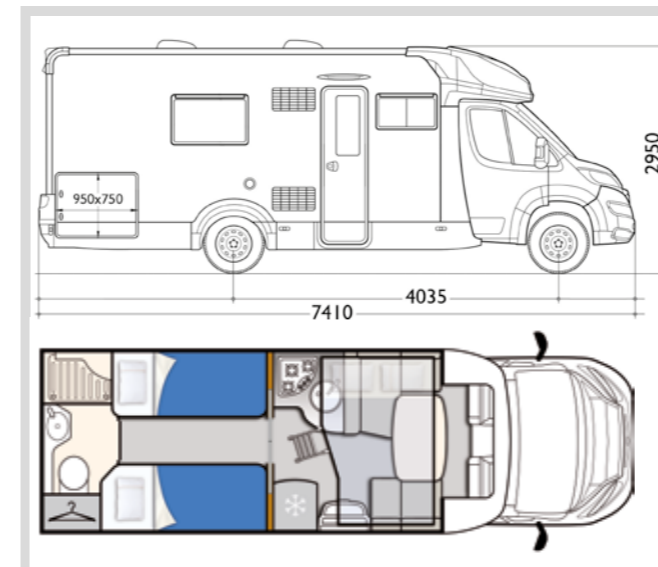

BARON 575

5	4	3500 KG 2,3 MJT 140 CV	3500 KG 2,2 L BLUEHDI 140 CV	COMBI 4

External length (mm) / External width (mm)	7410 / 2350
External height(mm) / Internal height (mm)	2950 / 2080
Wheelbase (mm)	4035
Maximum technically permissible weight (Kg)	3500
Weight in running conditions Min - Max (Kg)*	3015 - 3075
Max. user payload Min – Max (kg)*	425 - 485
Maximum towable weight (kg)	2000
Fresh water tank Lt. (total capacity when on the way)***	20 (118) /135
Standard heating system	COMBI 4 GAS

*The values shown represent the minimum value of the vehicle in the basic configuration, and the maximum value that includes the maximum weight of accessories available and that can be installed in the basic configuration in the factory. The homologation data refer to the Fiat chassis. The Citroen chassis is in registration phase.

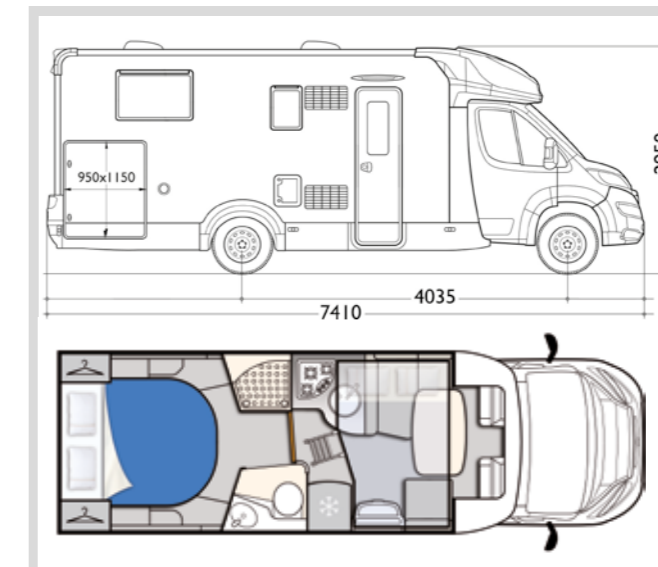

BARON 579

5	4	3500 KG 2,3 MJT 140 CV	3500 KG 2,2 L BLUEHDI 140 CV	COMBI 4

External length (mm) / External width (mm)	7410 / 2350
External height(mm) / Internal height (mm)	2950 / 2080
Wheelbase (mm)	4035
Maximum technically permissible weight (Kg)	3500
Weight in running conditions Min - Max (Kg)*	2995 - 3075
Max. user payload Min – Max (kg)*	425 - 505
Maximum towable weight (kg)	2000
Fresh water tank Lt. (total capacity when on the way)***	20 (118) /135
Standard heating system	COMBI 4 GAS

ALL INCLUSIVE

- MANUAL CLIMATE CONTROL
- CRUISE CONTROL
- DOUBLE AIRBAG
- ELECTRIC REAR VIEW MIRRORS
- PLEATED SLIDING FLY SCREEN ON LIVING UNIT DOOR
- CELL DOOR IN 2 POINTS WITH STORAGE, DUSTBIN AND CENTRAL LOCKING
- BEDS WITH MANUAL UP AND DOWN (WHERE APPLICABLE)
- TRANSFORMATION OF TWIN BEDS INTO A MAXI DOUBLE BED
- TV HOLDER
- SEAT COVERS
- SEITZ WINDOWS
- ENTRANCE DOOR WITH WINDOW
- EXTRACTOR HOOD
- SKY ROOF ON DOME (BARON LOW-PROFILE)
- APPROVED 5TH PLACE AS STANDARD (BARON LOW-PROFILE)
- MIDI HEKI (BARON COACHBUILD)
- EURO 6D POWER UNIT
- ESC

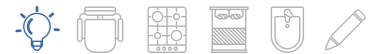

T-LOFT

FUNCTIONAL AND CREATED AROUND MAN



T-LOFT 450

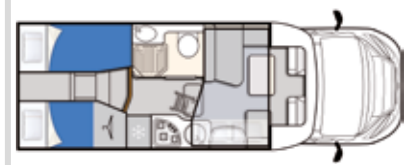

T-LOFT 529



T-LOFT 530

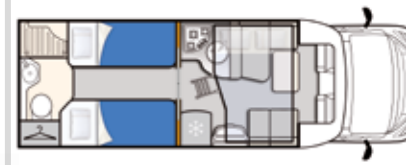

T-LOFT 531



T-LOFT 581



Opening skydome with blinder and flyscreen

Manual climate control

Garage doors with wide dimensions. Internal garage height up to 950x1150 mm

Cell door in 2 points with storage and dustbin



2950 MM

6990/7410 MM

5	4	3500 KG 2,3 MJT 140 CV	COMBI 4 DIESEL	142/150 LT.

EVERY VACATION IS A PERFECTLY BALANCED MIX OF RELAXATION, ADVENTURE AND WELLBEING.

T-Loft offers it to you all in one: the freedom of traveling easy on a journey of discovery of new and intriguing places, the pleasure of sleeping between two pillows before returning home satisfied and regenerated.

Photographs may show vehicles fitted with optional features and may content photography props not included in the standard specification of the vehicle.



Door separating the living area from the sleeping area

Handle for easy entry. Mirror at the entrance with LED light finish on the edge.

Large refrigerator 142 l / 150 l depending on model

Side bench for approved 5th seat with belt

Folding table. Movable and with 360° rotation

T-LOFT 581

THE UPHOLSTERY OF THE T-LOFT RANGE



WAVE BEIGE



WAVE GREY



T-LOFT 450

TYPES OF DINETTE ON THE T-LOFT RANGE

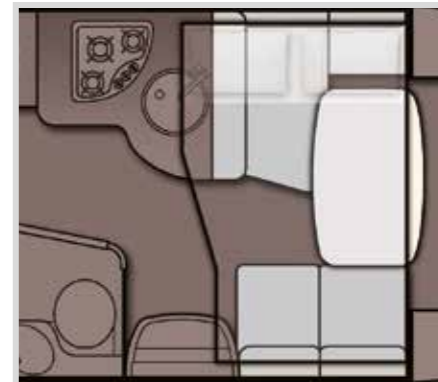

L-SHAPED DINETTE WITH DOUBLE SIDE BENCH

T-Loft 450 – T-Loft 531

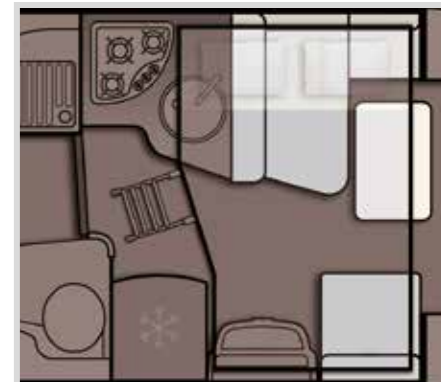

L-SHAPED DINETTE WITH SIDE BENCH

T-Loft 529 – T-Loft 530
T-Loft 581



Large Sky Roof with blind and flyscreen

Every space is functional to comfortably arrange everything

Convenient USB port for charging your multimedia systems

Swivel seats in the cab. Standard seat covers

T-LOFT 450



Cover panel under folding bed with integrated LED lights

T-LOFT 581

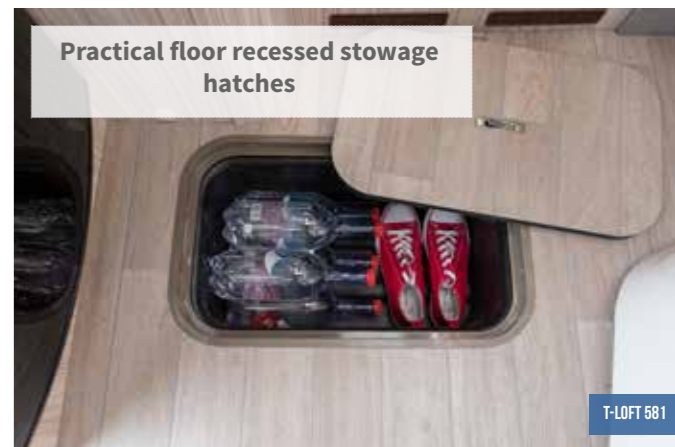

Practical floor recessed storage hatches

T-LOFT 581



T-LOFT 450



Electrically operated folding bed

1300 mm

1950 mm

T-LOFT 581



T-LOFT 450



Extractor hood

Kitchen window protection panel

Kitchen with 3 burners

Convenient and practical additional retractable top

T-LOFT 530



Functional spice rack

T-LOFT 530



Wall unit with double shelf for an optimal rationalisation of the space

T-LOFT 581



Generously sized kitchen drawers

Kitchen peninsula with curved opening door

T-LOFT 581



Sliding basket and shelf under the kitchen peninsula

T-LOFT 581



Sliding lounge baskets (T-Loft 450)

T-LOFT 450



T-LOFT 531



Ducted heating in the room.

- EVERYTHING IS IN ORDER IN THE COMPARTMENTS INSIDE THE STEPS.
- CABINETS EQUIPPED WITH POLE TO HANG YOUR CLOTHES.
- SOCKET FOR TV ANTENNA IN THE ROOM.
- SPEAKERS FOR SOUND DIFFUSION IN THE ROOM.





- STOWAGE UNDER THE TWIN BEDS, EASILY ACCESSIBLE THANKS TO THE OPENING DOORS
- CLOTHES HANGERS AND SHELVES FOR THE BEST STORAGE OF YOUR CLOTHES AND ITEMS



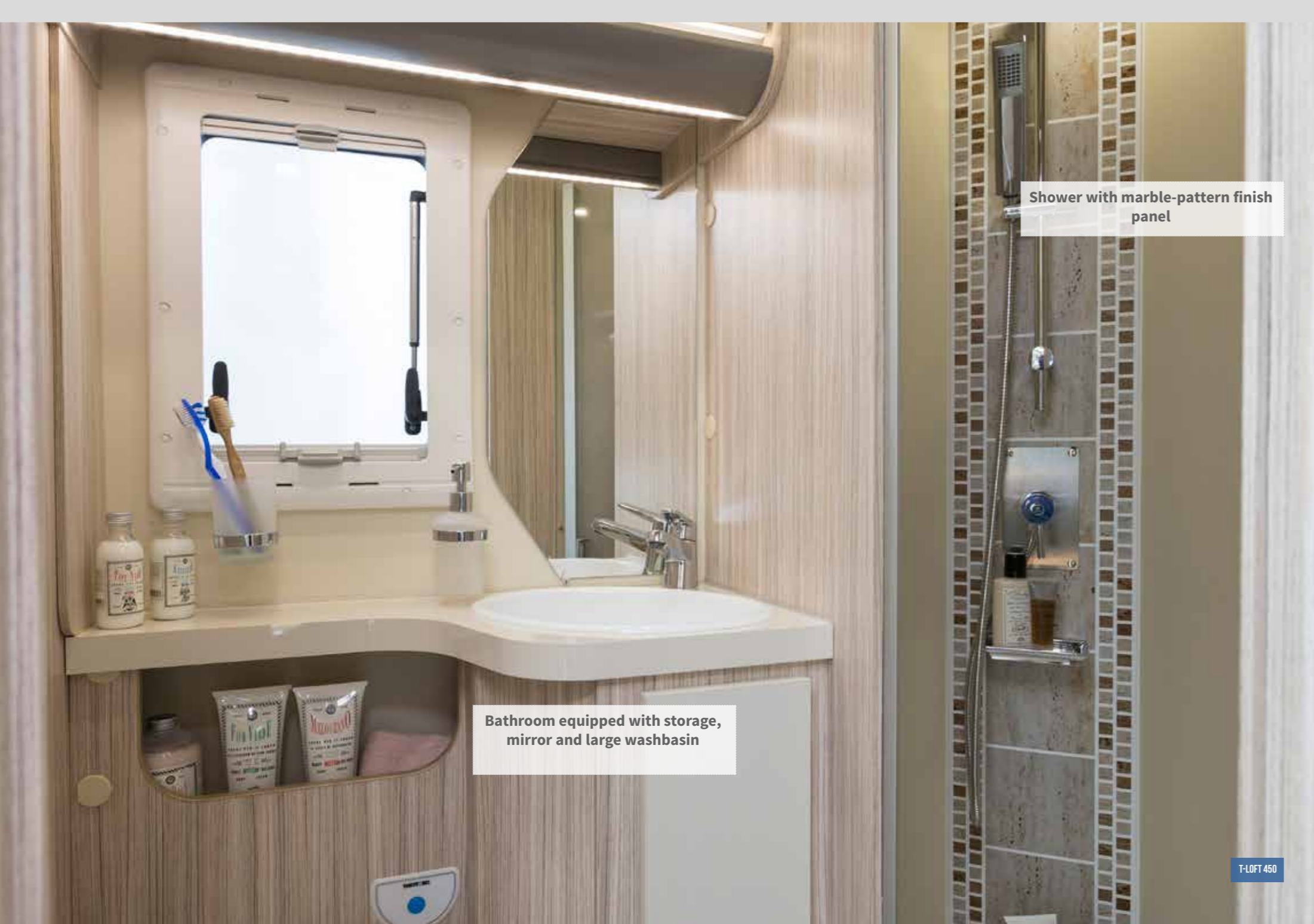

Shower with marble-pattern finish panel

Bathroom equipped with storage, mirror and large washbasin

T-LOFT 450

TYPES OF BATHROOMS ON THE T-LOFT RANGE

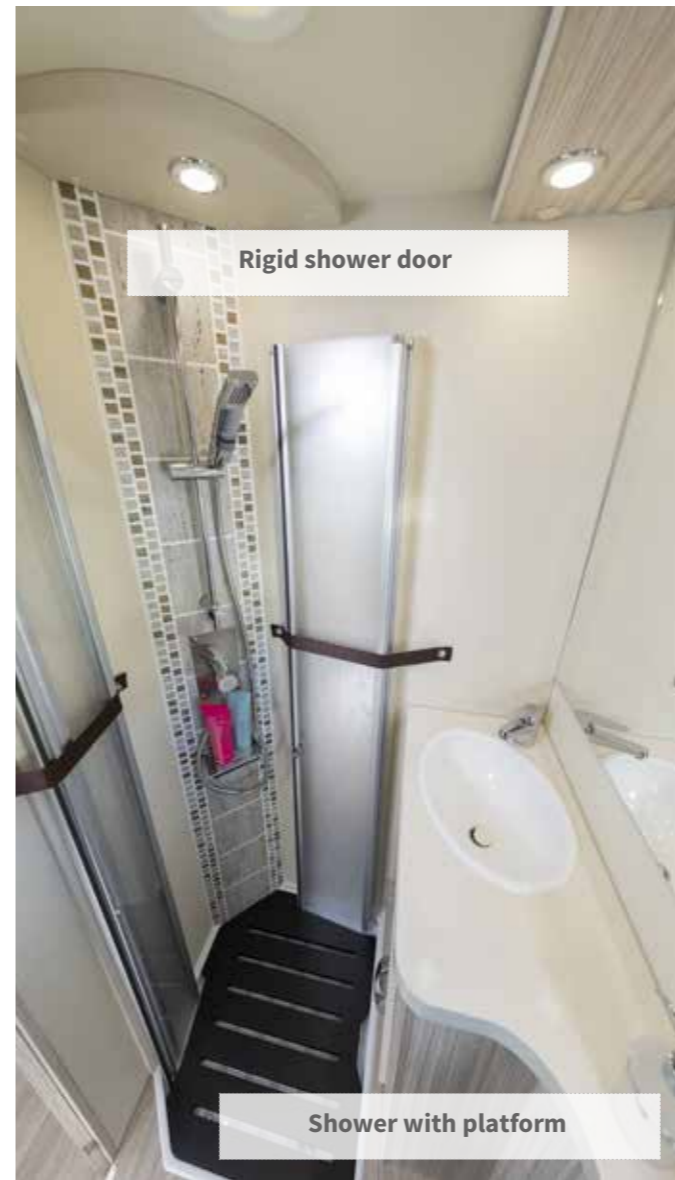

Rigid shower door

Shower with platform

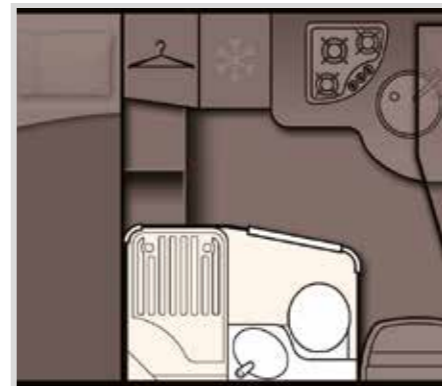

BATHROOM WITH SEPARATE SHOWER
T-Loft 450 – T-Loft 529

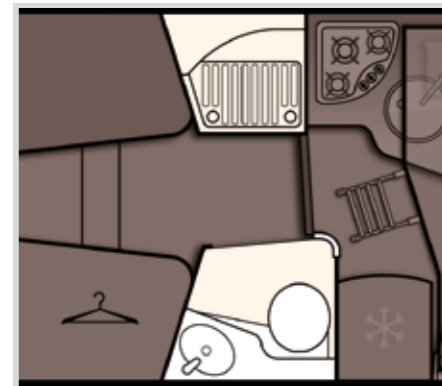

INDEPENDENT BATHROOM AND SHOWER
T-Loft 530 – T-Loft 581

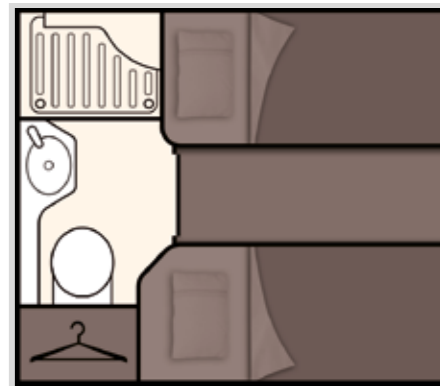

BATHROOM AND SHOWER AT THE END OF THE VEHICLE
T-Loft 531



- THE BATHROOM AREA IS VERY BRIGHT AND WELL VENTILATED THANKS TO THE WINDOW EQUIPPED WITH A BLIND AND FLYSCREEN.
- LARGE MIRROR AND WASHBASIN.
- WALL UNITS, CABINETS AND SHELVES TO KEEP EVERYTHING IN ORDER AND AT HAND

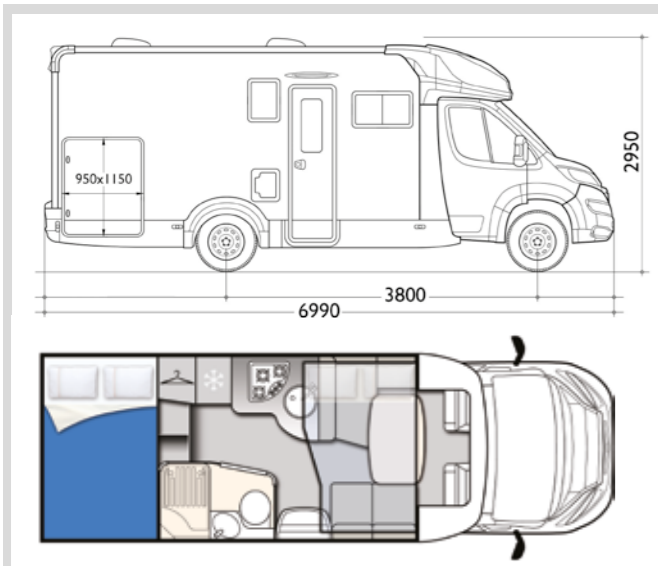

T-LOFT 450

5	4	3500 KG 2,3 MJT 140 CV	COMBI 4 DIESEL	142 LT.

External length (mm) / External width (mm)	6990 / 2350
External height(mm) / Internal height (mm)	2950 / 2080
Wheelbase (mm)	3800
Maximum technically permissible weight (Kg)	3500
Weight in running conditions Min - Max (Kg)*	2960 - 3080
Max. user payload Min - Max (kg)*	420 - 540
Maximum towable weight (kg)	2000
Fresh water tank Lt. (total capacity when on the way)***	20 (118) /100
Standard heating system	COMBI 4 DIESEL

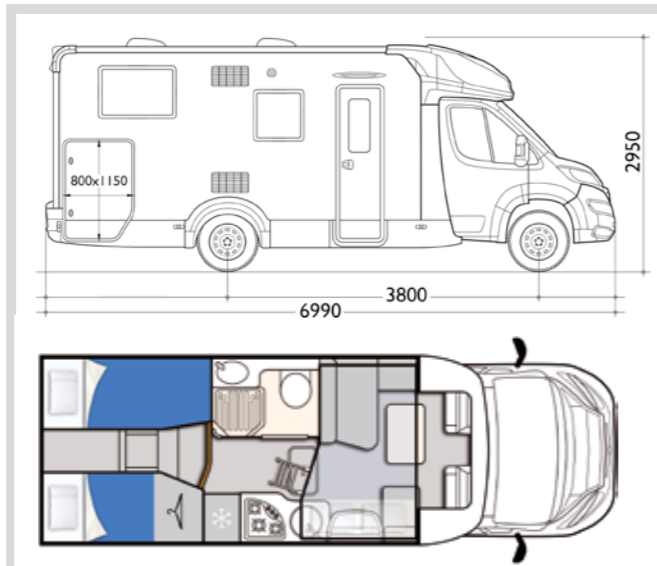

T-LOFT 529

5	4**	3500 KG 2,3 MJT 140 CV	COMBI 4 DIESEL	142 LT.

External length (mm) / External width (mm)	6990 / 2350
External height(mm) / Internal height (mm)	2950 / 2080
Wheelbase (mm)	3800
Maximum technically permissible weight (Kg)	3500
Weight in running conditions Min - Max (Kg)*	2970 - 3080
Max. user payload Min - Max (kg)*	420 - 530
Maximum towable weight (kg)	2000
Fresh water tank Lt. (total capacity when on the way)***	20 (118) /100
Standard heating system	COMBI 4 DIESEL

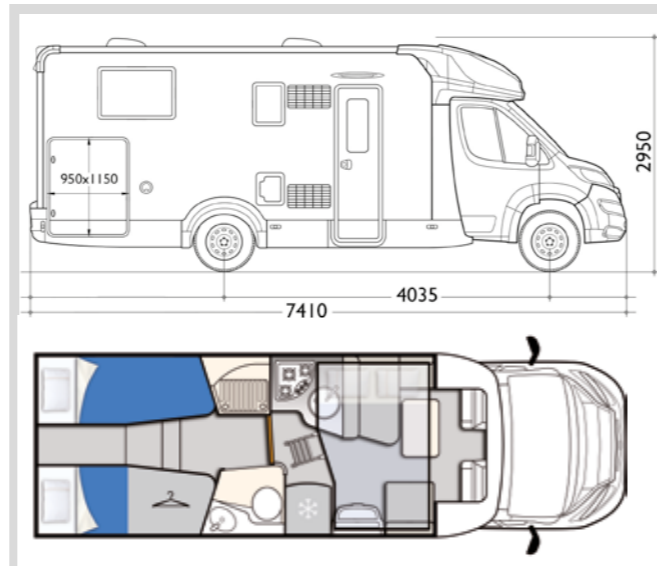

T-LOFT 530

5	4**	3500 KG 2,3 MJT 140 CV	COMBI 4 DIESEL	150 LT.

External length (mm) / External width (mm)	7410 / 2350
External height(mm) / Internal height (mm)	2950 / 2080
Wheelbase (mm)	4035
Maximum technically permissible weight (Kg)	3500
Weight in running conditions Min - Max (Kg)*	2980 - 3075
Max. user payload Min - Max (kg)*	425 - 520
Maximum towable weight (kg)	2000
Fresh water tank Lt. (total capacity when on the way)***	20 (118) /135
Standard heating system	COMBI 4 DIESEL

Transformation of twin beds into a maxi double bed - * Pls. Check 20 lts. filling before driving

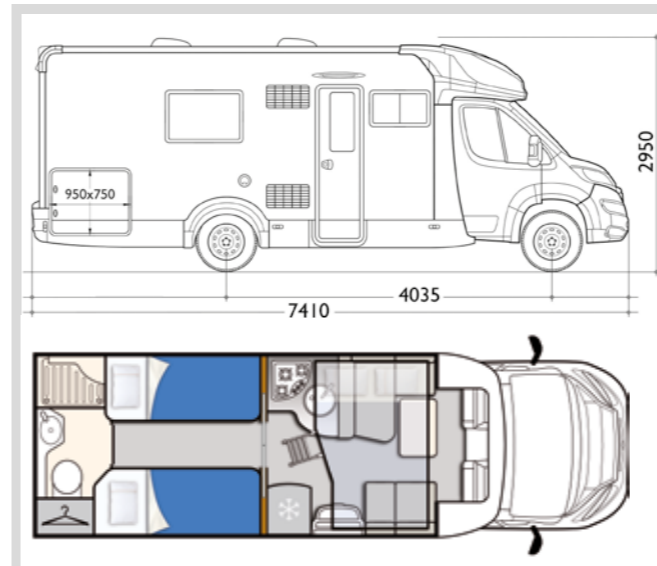

T-LOFT 531

5	4**	3500 KG 2,3 MJT 140 CV	COMBI 4 DIESEL	150 LT.

External length (mm) / External width (mm)	7410 / 2350
External height(mm) / Internal height (mm)	2950 / 2080
Wheelbase (mm)	4035
Maximum technically permissible weight (Kg)	3500
Weight in running conditions Min - Max (Kg)*	3015 - 3075
Max. user payload Min - Max (kg)*	425 - 485
Maximum towable weight (kg)	2000
Fresh water tank Lt. (total capacity when on the way)***	20 (118) /135
Standard heating system	COMBI 4 DIESEL

*The values shown represent the minimum value of the vehicle in the basic configuration, and the maximum value that includes the maximum weight of accessories available and that can be installed in the basic configuration in the factory.

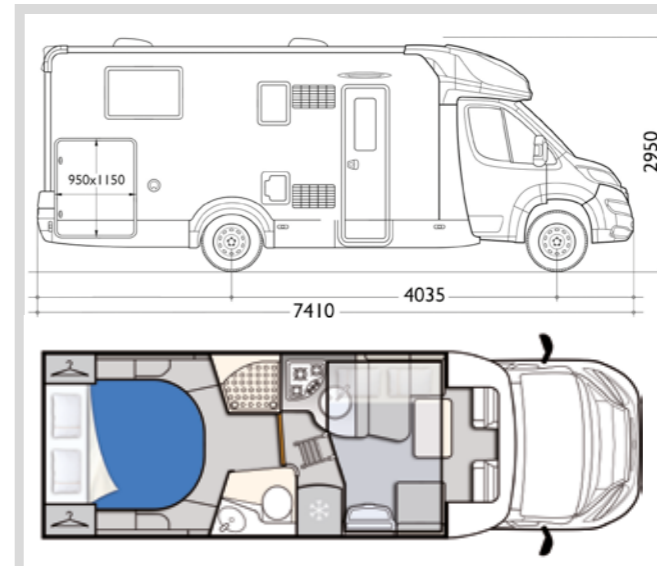

T-LOFT 581

5	4	3500 KG 2,3 MJT 140 CV	COMBI 4 DIESEL	150 LT.

External length (mm) / External width (mm)	7410 / 2350
External height(mm) / Internal height (mm)	2950 / 2080
Wheelbase (mm)	4035
Maximum technically permissible weight (Kg)	3500
Weight in running conditions Min - Max (Kg)*	2995 - 3075
Max. user payload Min - Max (kg)*	425 - 505
Maximum towable weight (kg)	2000
Fresh water tank Lt. (total capacity when on the way)***	20 (118) /135
Standard heating system	COMBI 4 DIESEL

ALL INCLUSIVE

- MANUAL CLIMATE CONTROL
- CRUISE CONTROL
- DOUBLE AIRBAG
- ELECTRIC REAR VIEW MIRRORS
- PLEATED SLIDING FLY SCREEN ON LIVING UNIT DOOR
- SEAT COVERS
- TV HOLDER
- CELL DOOR IN 2 POINTS WITH STORAGE AND DUSTBIN
- CENTRAL LOCKING
- SPEAKERS IN LIVING/SLEEPING AREA
- APPROVED 5TH SEAT
- FLOOR HATCH
- COMBI 4 DIESEL + CP PLUS
- BEDS WITH MANUAL UP AND DOWN (WHERE APPLICABLE)
- TRANSFORMATION OF TWIN BEDS INTO A MAXI DOUBLE BED
- SKY ROOF
- EURO 6D POWER UNIT
- ESC

MODEL	T-LOFT 450	T-LOFT 529	T-LOFT 530	T-LOFT 531	T-LOFT 581
Wheels dimensions	15" (S)	15" (S)	15" (S)	15" (S)	15" (S)
Manual air conditioning	S	S	S	S	S
Driver and Passenger airbag	S	S	S	S	S
Cruise Control with speed limiter	S	S	S	S	S
ABS / ESC / Traction+	S / S / O	S / S / O	S / S / O	S / S / O	S / S / O
Swivelling driver' and passenger's seat	S	S	S	S	S
Cab seat covers	S	S	S	S	S
Frontbumper in white	S	S	S	S	S
Dimensions and places					
Bed in Dinette	O	O	O	O	O
Rear Bed (mm)	1400 X2200	830x2000 + 830x1900 -1820x2120	830x2000X2 -1820x2120	750X1900-750X2050 -1400x2120	1600X1900
Bed in Dinette (mm)	2160x1100x600	2160x960x510	2160x1070x570	2160x1140x870	2160x1070x570
Overcab bed (mm)	-	-	-	-	-
Elevating Bed (mm)	1950X1300X1100	1950X1300X1100	1950X1300X1100	1950X1300X1100	1950X1300X1100
Additional seat rear bed	-	S	S	S	-
Locker (useful opening, mm)	1150X950X2	1150X800X2	1150X950X2	950X750 DX - 850X450 SX	1150X950X2
Max. internal garage height (mm)	1150	1190	1180	770	1170
Floor / walls / roof thickness (mm)	54/31/31	54/31/31	54/31/31	54/31/31	54/31/31
Floor / walls / roof material*	VTR/VTR/VTR	VTR/VTR/VTR	VTR/VTR/VTR	VTR/VTR/VTR	VTR/VTR/VTR
Fiberglass roof, hail-proof	S	S	S	S	S
Installations					
Burners / Gas oven / Suction hood	3 / O / S	3 / O / S	3 / O / S	3 / O / S	3 / O / S
Automatic trivalent fridge (220V, 12V, gas) (L)	142 L	142 L	149 L	149 L	149 L
Space for 2 gas bottles (tot. Max 15 Kg)	2X15 KG	2X15 KG	2X15 KG	2X15 KG	2X15 KG
Bathroom window (double opaque glass)	S	S	S	S	S
Shower tray with double drain	S	S	-	S	-
Integrated and isolated entry step	S/O	S/O	S/O	S/O	S/O
Heated garage locker	S	S	S	S	S
Skylight					
Panoramic roof - OPEN SKY (mm)	S	S	S	S	S
Rear skylight (mm)	400X400 (S) / 960X655 (O)	400X400 (S) / 960X655 (O)	400X400 (S) / 960X655 (O)	400X400 (S) / 960X655 (O)	400X400 (S) / 960X655 (O)
Central skylight (mm)	400X400	400X400	400X400	400X400	400X400
Dinette skylight (mm)	-	-	-	-	-
Skylight toilette/shower (mm)	-	-	-	-	-
Double-glazed windows with blind / mosquito net	S	S	S	S	S
Equipments					
Cab separation curtain	S	S	S	S	S
Rear bed manually adjustable	S	-	-	-	S
Beds with staves	S	S	S	S	S
Swivelling LCD holder	S	S	S	S	S
Internal LED lightening	S	S	S	S	S
Exteriors					
Entrance door with fixed window	S	S	S	S	S
Flyscreen for entrance door	S	S	S	S	S
Entrance door with two central locking points	S	S	S	S	S
External LED light	S	S	S	S	S

* VTR = Fibreglass

S= Standard O= Optional - = Not Available





MAGNUM

BUSINESS CLASS? NO, MAGNUM CLASS!



MAGNUM 450



MAGNUM 529



MAGNUM 530

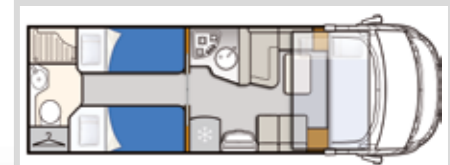

MAGNUM 531



MAGNUM 581



Midi Heki 50x70 cm

Pleated blinds

DRL

2-point type door, with window and flyscreen. Central locking.







2950 MM

6990/7410 MM

**LEAVE YOUR WORK, THE CITY AND THE BUSTLE BEHIND.
CLIMB INTO YOUR MAGNUM AND YOU'RE OFF!**

With Magnum, you'll be sure to reach your destination because the first one is ... your Magnum!
Magnum is the Elnagh top of the line: majestic, elegant and hospitable.

 5	 4	 3500 KG 2,3 MJT 140 CV	 COMBI 4 DIESEL	 142/150 LT.
--	--	---	--	--

Photographs may show vehicles fitted with optional features and may content photography props not included in the standard specification of the vehicle.



THE UPHOLSTERY OF THE MAGNUM RANGE



WAVE BEIGE



WAVE GREY



TYPES OF DINETTE ON THE MAGNUM RANGE

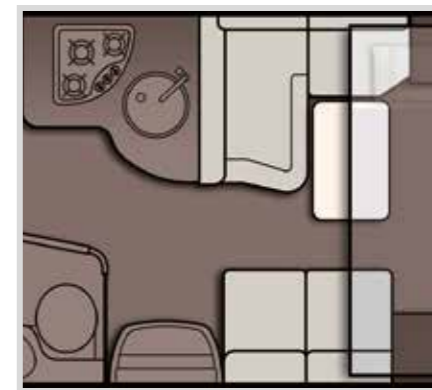

L-SHAPED DINETTE WITH DOUBLE SIDE BENCH

Magnum 450 – Magnum 531

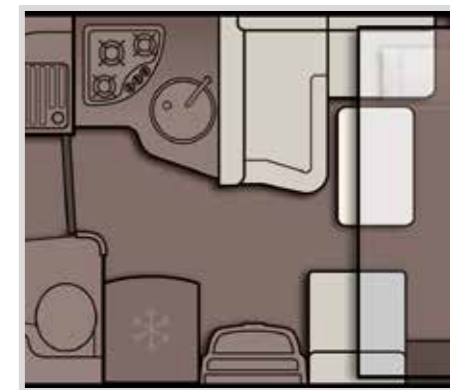

L-SHAPED DINETTE WITH SIDE BENCH

Magnum 529 – Magnum 530
Magnum 581



Handle for easy entry. Mirror at the entrance with LED light finish on the edge.

Cover panel under folding bed with integrated LED lights

Practical floor recessed stowage hatches

MAGNUM 631



Ergonomic, height-adjustable swivel cab seats with double armrest and integrated seat belt

Comfortable glove compartment in the cab

MAGNUM 681



Fabric panel covering and comfortable storage pockets

MAGNUM 681



1400 mm

1900 mm

MAGNUM 681



Panoramic rooflight 70x50 cm

MAGNUM 631

- FOLD-DOWN BED WITH SPACE-SAVING MOVEMENT: EVEN WHEN LOWERED, IT LEAVES THE DINETTE FREE AND USABLE
- SIDE BENCH FOR 5TH APPROVED SEAT WITH BELT
- PLEATED BLINDS IN THE CAB
- FUNCTIONAL SUNSHADE FOR A MORE COMFORTABLE AND SAFE DRIVING



Transparent rooflight 40x40 cm

Wall unit with double shelf for an optimal rationalisation of the space

Kitchen window protection panel

Partition door from sleeping area

Kitchen with 3 burners

MAGNUM 581



Large refrigerator 142 l / 150 l depending on model

Practical spice rack

MAGNUM 529



Extractor hood



Generously sized kitchen drawers

Kitchen peninsula with curved opening door

MAGNUM 581



Sliding basket and shelf under the kitchen peninsula

MAGNUM 531



Sliding lounge baskets (Magnum 450)

MAGNUM 450



Transparent rooflight 40x40 cm with blind and flyscreen

Handy side shelves

Transformation of twin beds into a maxi double bed up to 2000x2100 mm

Spotlights for evening reading

MAGNUM 529



MAGNUM 530



MAGNUM 530

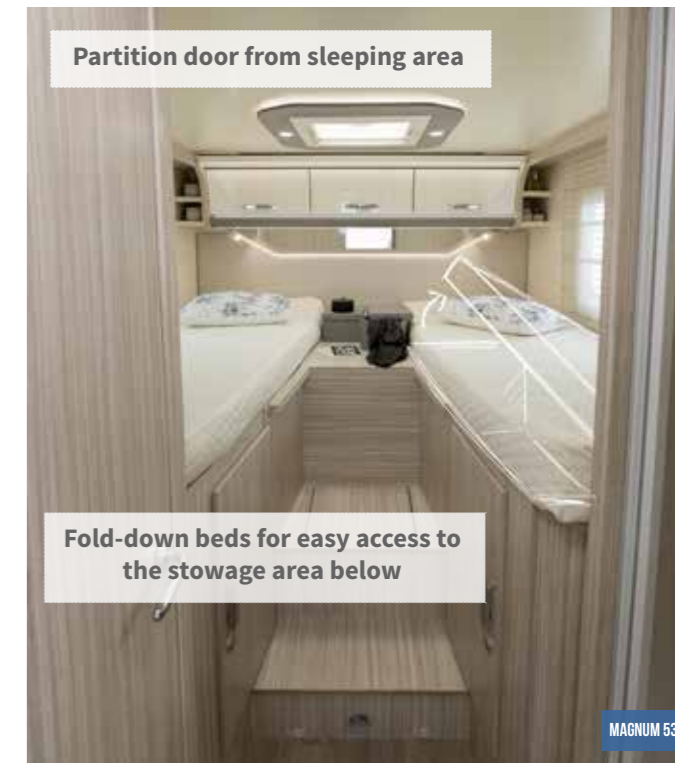

Partition door from sleeping area

Fold-down beds for easy access to the storage area below

MAGNUM 530



Speakers for sound diffusion in the room

Maximum relaxation thanks to reclining backrests (Magnum 531)

MAGNUM 531



MAGNUM 531



Large and functional storage compartment under the double bed

MAGNUM 581



Height-adjustable bed

MAGNUM 581



Height-adjustable garage bed
1400x2060 mm

MAGNUM 450



Stowage compartments inside the steps

MAGNUM 450



MAGNUM 581

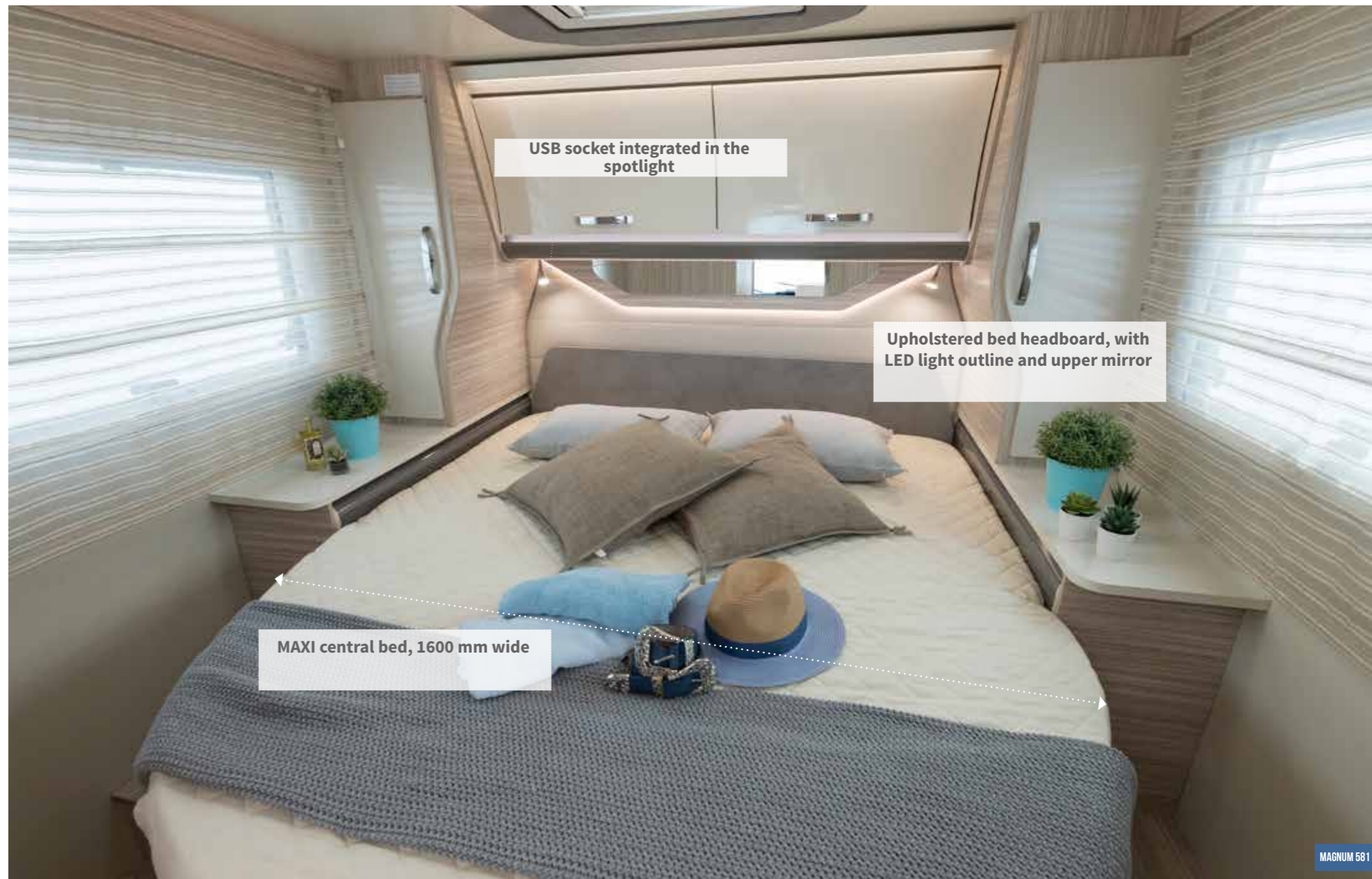

USB socket integrated in the spotlight

Upholstered bed headboard, with LED light outline and upper mirror

MAXI central bed, 1600 mm wide

MAGNUM 581

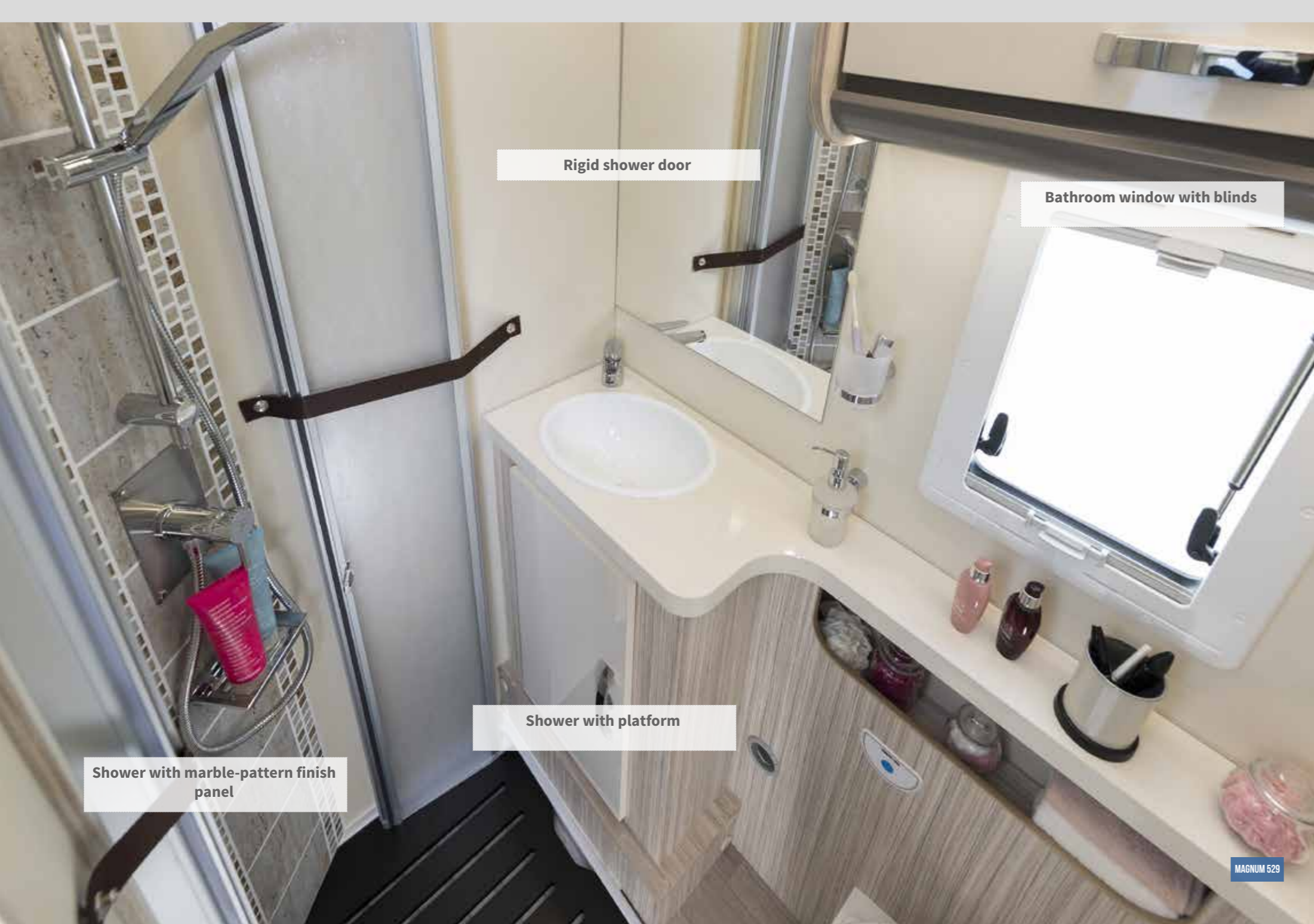

TYPES OF BATHROOMS ON THE MAGNUM RANGE

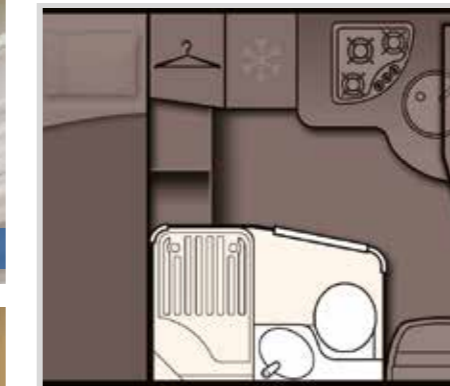

BATHROOM WITH SEPARATE SHOWER
Magnum 450 – Magnum 529

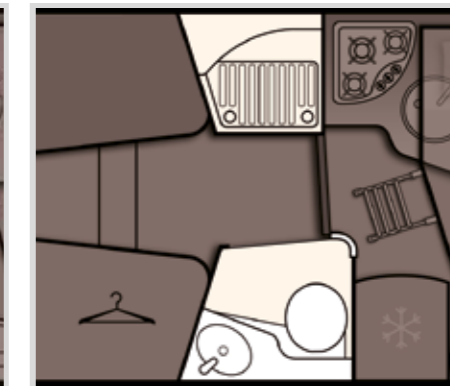

INDEPENDENT BATHROOM AND SHOWER
Magnum 530 – Magnum 581



BATHROOM AND SHOWER AT THE END OF THE VEHICLE
Magnum 531



- THE BATHROOM AREA IS VERY BRIGHT AND WELL VENTILATED THANKS TO THE WINDOW EQUIPPED WITH A BLIND AND FLYSCREEN.
- LARGE MIRROR AND WASHBASIN.
- WALL UNITS, CABINETS AND SHELVES TO KEEP EVERYTHING IN ORDER AND AT HAND

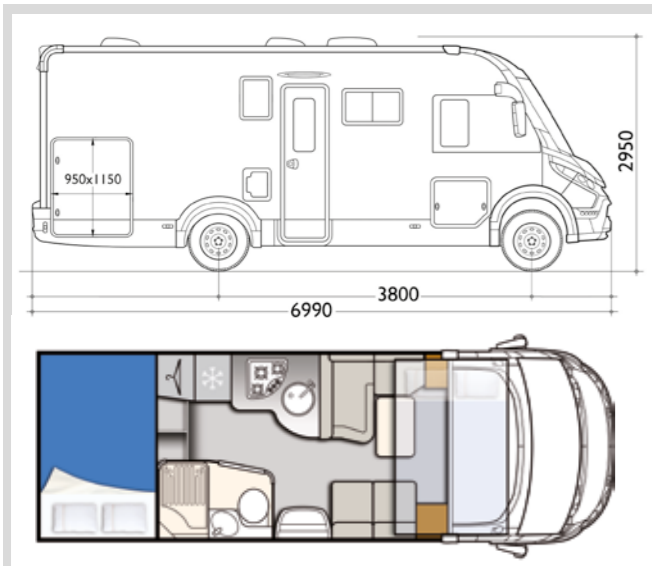

MAGNUM 450

5	4	3500 KG 2,3 MJT 140 CV	COMBI 4 DIESEL	142 LT.

External length (mm) / External width (mm)	6990 / 2350
External height(mm) / Internal height (mm)	2950 / 2080
Wheelbase (mm)	3800
Maximum technically permissible weight (Kg)	3500
Weight in running conditions Min - Max (Kg)*	2950 - 3080
Max. user payload Min - Max (kg)*	420 - 550
Maximum towable weight (kg)	2000
Fresh water tank Lt. (total capacity when on the way)***	20 (118) /100
Standard heating system	COMBI 4 DIESEL

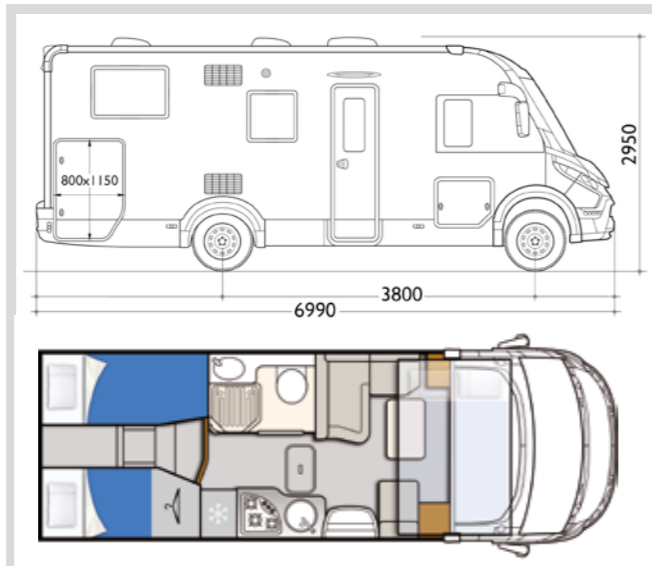

MAGNUM 529

5	4**	3500 KG 2,3 MJT 140 CV	COMBI 4 DIESEL	142 LT.

External length (mm) / External width (mm)	6990 / 2350
External height(mm) / Internal height (mm)	2950 / 2080
Wheelbase (mm)	3800
Maximum technically permissible weight (Kg)	3500
Weight in running conditions Min - Max (Kg)*	2960 - 3080
Max. user payload Min - Max (kg)*	420 - 540
Maximum towable weight (kg)	2000
Fresh water tank Lt. (total capacity when on the way)***	20 (118) /100
Standard heating system	COMBI 4 DIESEL

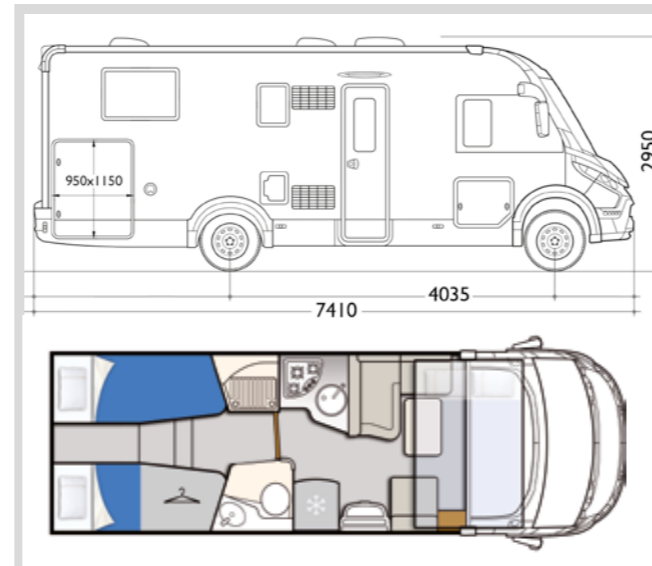

MAGNUM 530

5	4**	3500 KG 2,3 MJT 140 CV	COMBI 4 DIESEL	150 LT.

External length (mm) / External width (mm)	7410 / 2350
External height(mm) / Internal height (mm)	2950 / 2080
Wheelbase (mm)	4035
Maximum technically permissible weight (Kg)	3500
Weight in running conditions Min - Max (Kg)*	2980 - 3075
Max. user payload Min - Max (kg)*	425 - 520
Maximum towable weight (kg)	2000
Fresh water tank Lt. (total capacity when on the way)***	20 (118) /135
Standard heating system	COMBI 4 DIESEL

Transformation of twin beds into a maxi double bed - * Pls. Check 20 lts. filling before driving

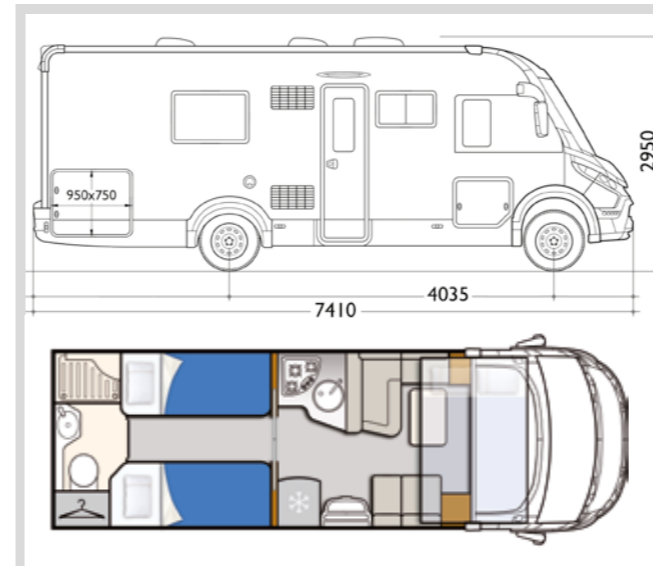

MAGNUM 531

5	4**	3500 KG 2,3 MJT 140 CV	COMBI 4 DIESEL	150 LT.

External length (mm) / External width (mm)	7410 / 2350
External height(mm) / Internal height (mm)	2950 / 2080
Wheelbase (mm)	4035
Maximum technically permissible weight (Kg)	3500
Weight in running conditions Min - Max (Kg)*	3010 - 3075
Max. user payload Min - Max (kg)*	425 - 490
Maximum towable weight (kg)	2000
Fresh water tank Lt. (total capacity when on the way)***	20 (118) /135
Standard heating system	COMBI 4 DIESEL

*The values shown represent the minimum value of the vehicle in the basic configuration, and the maximum value that includes the maximum weight of accessories available and that can be installed in the basic configuration in the factory.

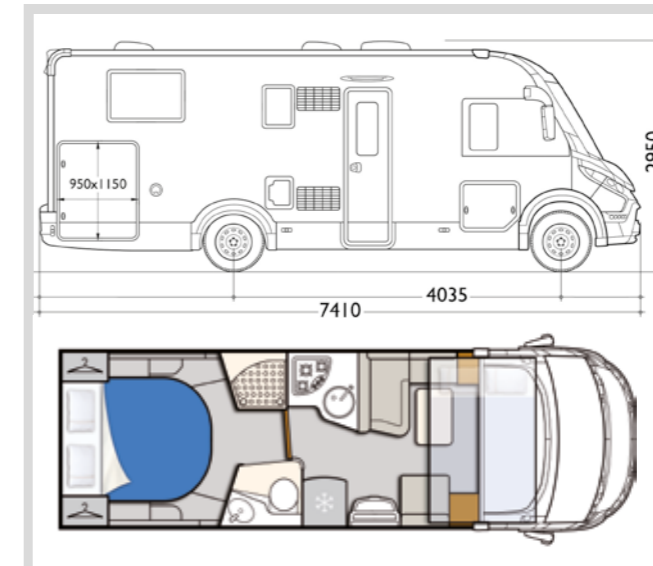

MAGNUM 581

5	4	3500 KG 2,3 MJT 140 CV	COMBI 4 DIESEL	150 LT.

External length (mm) / External width (mm)	7410 / 2350
External height(mm) / Internal height (mm)	2950 / 2080
Wheelbase (mm)	4035
Maximum technically permissible weight (Kg)	3500
Weight in running conditions Min - Max (Kg)*	3015 - 3075
Max. user payload Min - Max (kg)*	425 - 485
Maximum towable weight (kg)	2000
Fresh water tank Lt. (total capacity when on the way)***	20 (118) /135
Standard heating system	COMBI 4 DIESEL

MAGNUM

ALL INCLUSIVE

- MANUAL CLIMATE CONTROL
- CRUISE CONTROL
- DOUBLE AIRBAG
- ELECTRIC REAR VIEW MIRRORS
- PLEATED SLIDING FLY SCREEN ON LIVING UNIT DOOR
- PLEATED BLINDS
- PANORAMIC ROOFLIGHT 50X70 CM
- TV HOLDER
- CELL DOOR IN 2 POINTS WITH STORAGE AND DUSTBIN
- CENTRAL LOCKING
- SPEAKERS IN LIVING/SLEEPING AREA
- APPROVED 5TH SEAT
- FLOOR HATCH
- COMBI 4 DIESEL + CP PLUS
- BEDS WITH MANUAL UP AND DOWN (WHERE APPLICABLE)
- TRANSFORMATION OF TWIN BEDS INTO A MAXI DOUBLE BED
- EURO 6D POWER UNIT
- ESC
- DRL

MODEL	MAGNUM 450	MAGNUM 529	MAGNUM 530	MAGNUM 531	MAGNUM 581
Wheels dimensions	15" (S)	15" (S)	15" (S)	15" (S)	15" (S)
Manual air conditioning	S	S	S	S	S
Driver and Passenger airbag	S	S	S	S	S
Cruise Control with speed limiter	S	S	S	S	S
ABS / ESC / Traction+	S / S / O	S / S / O	S / S / O	S / S / O	S / S / O
Swivelling driver' and passenger's seat	S	S	S	S	S
DRL (Day running light)	S	S	S	S	S
Dimensions and places					
Bed in Dinette	0	0	0	0	0
Rear Bed (mm)	1400 X2200	830x2000 + 830x1900 -1820x2120	830x2000X2 -1820x2120	750X1900-750X2050 -1400x2120	1600X1900
Bed in Dinette (mm)	2160x1200x600	2160x960x510	2160x1200x570	2160x1200x870	2160x1200x570
Overcab bed (mm)	-	-	-	-	-
Elevating Bed (mm)	1900X1400	1900X1400	1900X1400	1900X1400	1900X1400
Additional seat rear bed	-	S	S	S	-
Locker (useful opening, mm)	1150X950X2	1150X800X2	1150X950X2	950X750 DX - 850X450 SX	1150X950X2
Max. internal garage height (mm)	1150	1190	1180	770	1170
Floor / walls / roof thickness (mm)	54/31/31	54/31/31	54/31/31	54/31/31	54/31/31
Floor / walls / roof material*	VTR/VTR/VTR	VTR/VTR/VTR	VTR/VTR/VTR	VTR/VTR/VTR	VTR/VTR/VTR
Fiberglass roof, hail-proof	S	S	S	S	S
Installations					
Burners / Gas oven / Suction hood	3 / 0 / S	3 / 0 / S	3 / 0 / S	3 / 0 / S	3 / 0 / S
Automatic trivalent fridge (220V, 12V, gas) (L)	142 L	142 L	149 L	149 L	149 L
Space for 2 gas bottles (tot. Max 15 Kg)	2X15 KG	2X15 KG	2X15 KG	2X15 KG	2X15 KG
Bathroom window (double opaque glass)	S	S	S	S	S
Shower tray with double drain	S	S	-	S	-
Integrated and isolated entry step	S/O	S/O	S/O	S/O	S/O
Heated garage locker	S	S	S	S	S
Skylight					
Panoramic roof - OPEN SKY (mm)	-	-	-	-	-
Rear skylight (mm)	400X400 (S) / 960X655 (O)	400X400 (S) / 960X655 (O)	400X400 (S) / 960X655 (O)	400X400 (S) / 960X655 (O)	400X400 (S) / 960X655 (O)
Central skylight (mm)	400X400	400X400	400X400	400X400	400X400
Dinette skylight (mm)	-	700X500	700X500 (S) / 960X655 (O)	700X500 (S) / 960X655 (O)	700X500 (S) / 960X655 (O)
Skylight toilette/shower (mm)	-	-	-	-	-
Double-glazed windows with blind / mosquito net	S	S	S	S	S
Equipments					
Pleated cab blind	S	S	S	S	S
Rear bed manually adjustable	S	-	-	-	S
Beds with staves	S	S	S	S	S
Swivelling LCD holder	S	S	S	S	S
Internal LED lightening	S	S	S	S	S
Exteriors					
Entrance door with fixed window	S	S	S	S	S
Flyscreen for entrance door	S	S	S	S	S
Entrance door with two central locking points	S	S	S	S	S
External LED light	S	S	S	S	S

* VTR = Fibreglass

S= Standard O= Optional - = Not Available





SEA S.p.A. operates with an Integrated Environment and Safety Management System.

The masses indicated in this catalogue refer to the provisions of European Directive 2007/46/EC.

MASS IN RUNNING ORDER

It includes the weight of the empty BASE vehicle, of the driver (75 kg), 100% of the fuel (60-l tank), fresh water (tank filled with 20 l while travelling), and a gas tank for living purposes (20 kg). The mass in running order, and consequently the payload and/or certified seats may vary depending on the accessories installed.

PAYLOAD

This consists of the difference between the maximum technically permissible laden mass and the mass in running order. It includes elements for living purposes, the transported passengers defined by the manufacturer (driver excluded), and the personal effects. The payload calculation is based on the following parameters: 75 kg for each passenger (driver excluded), 10 kg of baggage for each passenger and for the driver, 10 kg for each metre of length of the vehicle, plus the remaining payload, which can be used for the installation of accessories or for additional baggage. All masses and loads of the empty vehicle have a tolerance of +/- 5%, in compliance with Directive 2007/46/EC. Any optional equipment increases the mass in running order and decreases the payload. The weight of non-standard accessories is not included in the mass in running order indicated in this catalogue. Additional accessories and devices reduce the payload by a quantity equal to their weight; the incidence of the weight of the individual accessories is shown in the special column in the technical data sheets or can be requested at our dealers. In case certain accessories are installed (for example, additional elements such as coupling device or motorbike rack), the mass of these acces-

sories will affect the payload, possibly reducing it along with the number of certified seats. Please make sure that the maximum loads on the axles and the maximum technically permissible load mass are not exceeded during the complete loading phase of the vehicle. The regulations and requirements of each country may entail changes in the characteristics of this table. The number of certified seats may vary depending on the traffic regulations in force in each country.

NOTES

Elnagh reserves itself the right to change the characteristics and the furnishings of all its models with no advance notice required; all data contained in this leaflet must therefore be considered approximate and non-binding. Despite thorough checks of the contents, we cannot exclude possible printing and/or translating errors. This catalogue does not constitute contractual documentation. Any reproduction, including in part, of the test or of the content of this document is prohibited. The indicated weights are exclusively approximated. Tolerances of +/- 5 % are allowed. Generally speaking, special equipment and options increase the no-load weight and entail a reduction in the payload. We hereby decline any and all responsibility in case structural changes are made to the vehicle; any assembly, disassembly or changes carried out by unauthorised workshops may jeopardise your safety and cause the warranty clauses to be forfeited. For additional information on installation and technical details, please contact one of our dealers.

Garage weight capacity up to 300 kg

The load for the rear stowage has a maximum limit of 300 kg, uniformly distributed, in respect of the distribution of the maximum permissible loads on the front / rear axles.

